

# 1999 Technical Specifications

# THREADED HEADSETS

## *Record, Chorus, Athena*

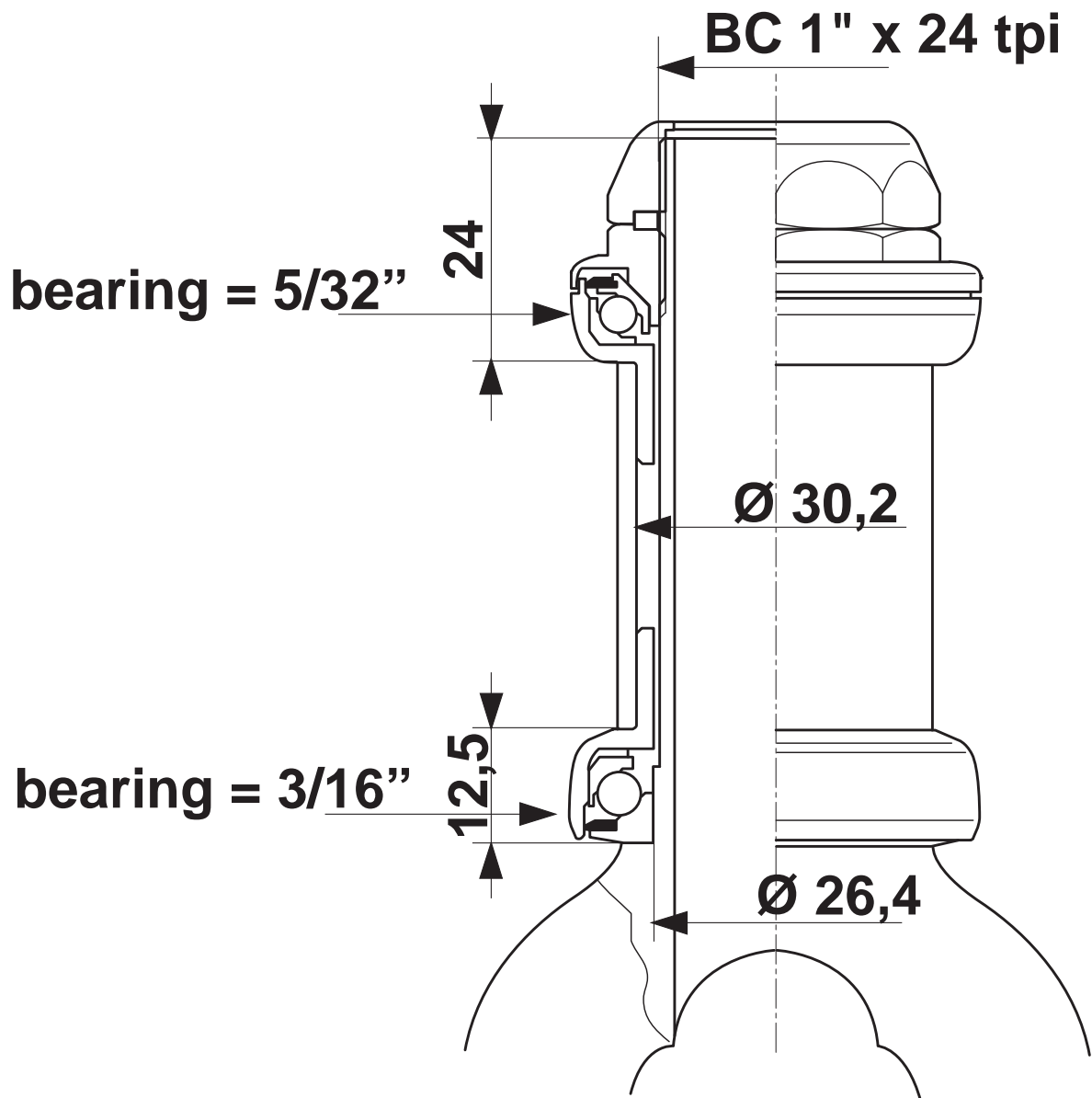

model	A	B	C	D	E
<i>Record</i>	32	26.4	30.2	24	12.5
<i>Chorus</i>	32	26.4	30.2	24	12.5
<i>Athena</i>	32	26.4	30.2	24	12.5

# THREADLESS HEADSETS

## *Record, Chorus*

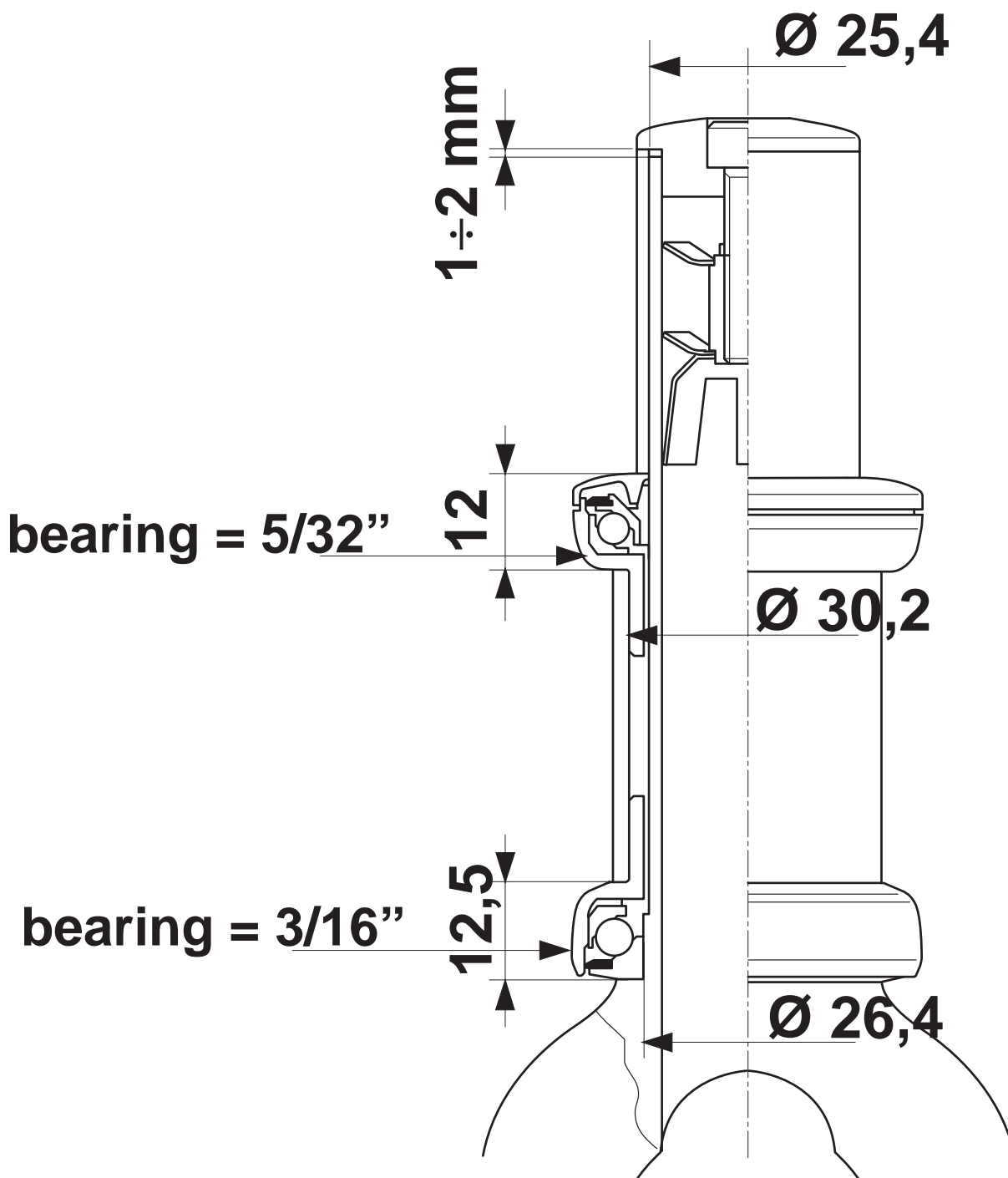

# BOTTOM BRACKETS

## *Record, Chorus*

BSC. threading

model	weight	spindle length
<b>RECORD</b>	190g	102mm

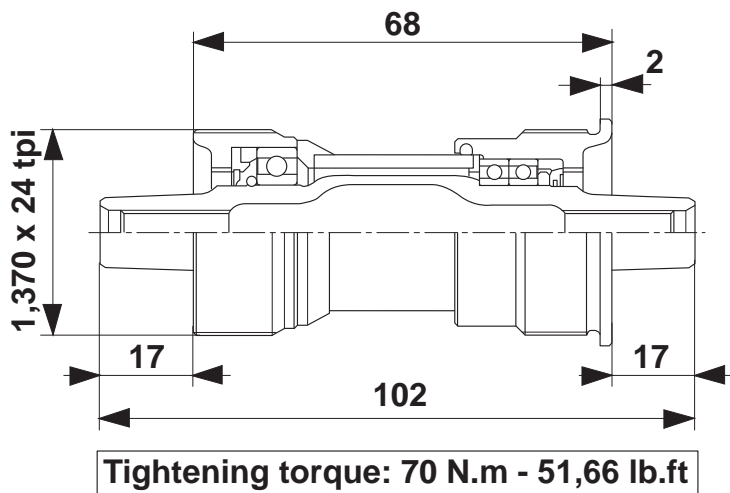

ITA. threading

model	weight	spindle length
<b>RECORD</b>	193g	102mm

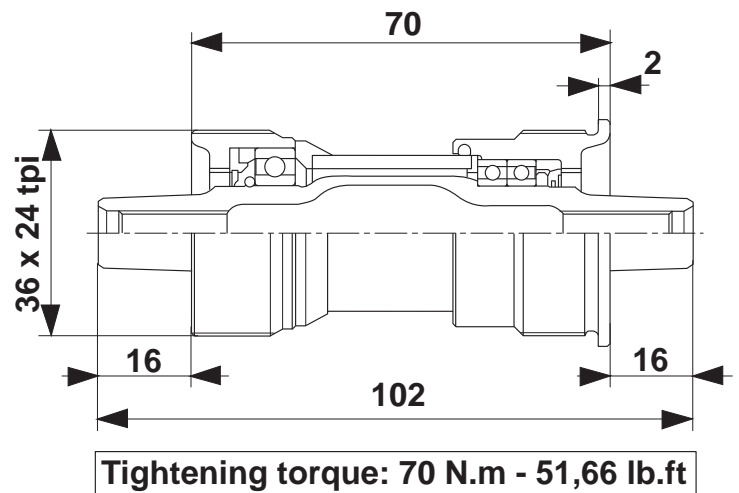

BSC. threading

model	weight	spindle length
<b>CHORUS</b>	223g	102mm

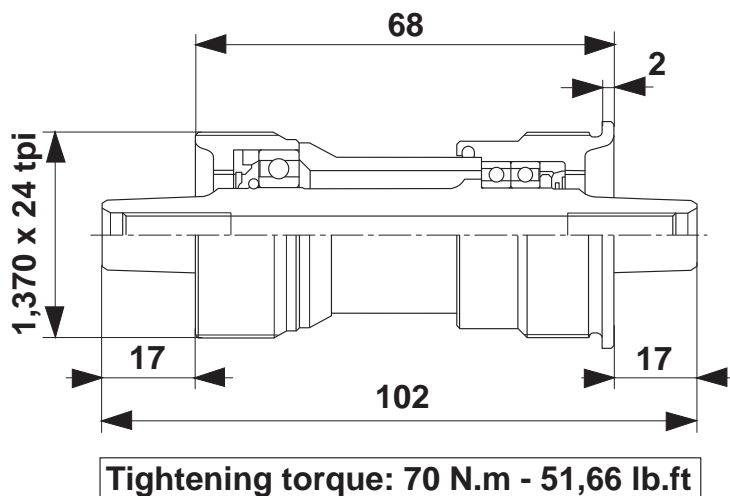

ITA. threading

model	weight	spindle length
<b>CHORUS</b>	226g	102mm

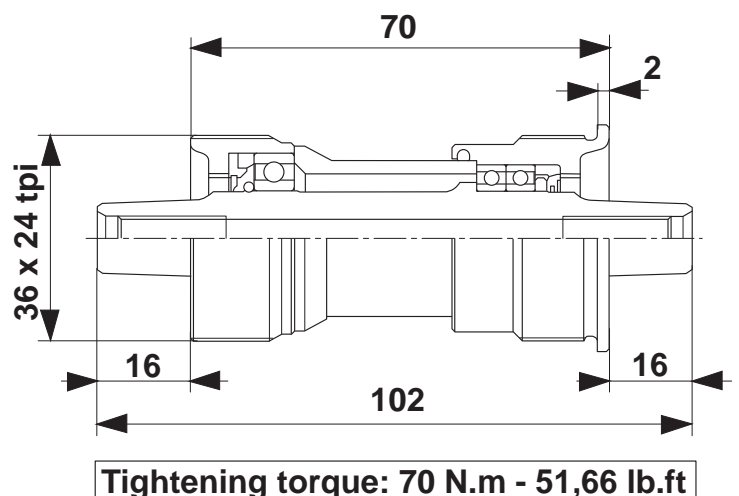

# BOTTOM BRACKETS

## *Athena, Racing T*

ATHENA / RACING T		BSC. threading
model	weight	spindle length
ATHENA	276 g.	111 mm

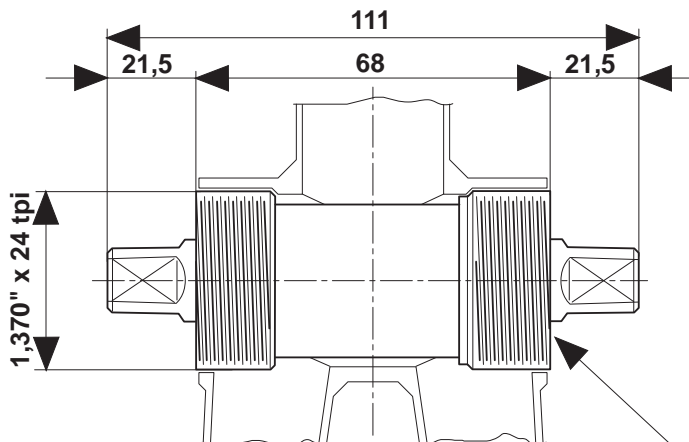

Campagnolo tool: 7130036  
Tightening torque: 70 N.m - 51,66 lb.ft

ATHENA / RACING T		ITA. threading
model	weight	spindle length
ATHENA	278 g.	111 mm

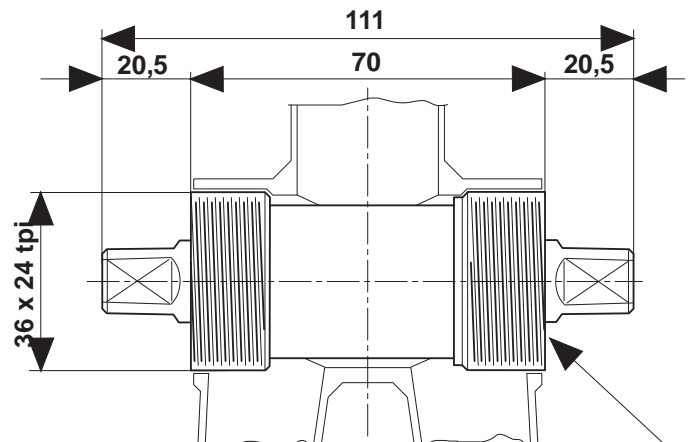

Campagnolo tool: 7130036  
Tightening torque: 70 N.m - 51,66 lb.ft

### RACING T with seat-tube $\varnothing \geq 32\text{mm}$ :

RACING T		BSC. threading
model	weight	spindle length
RACING T	294 g.	115,5mm

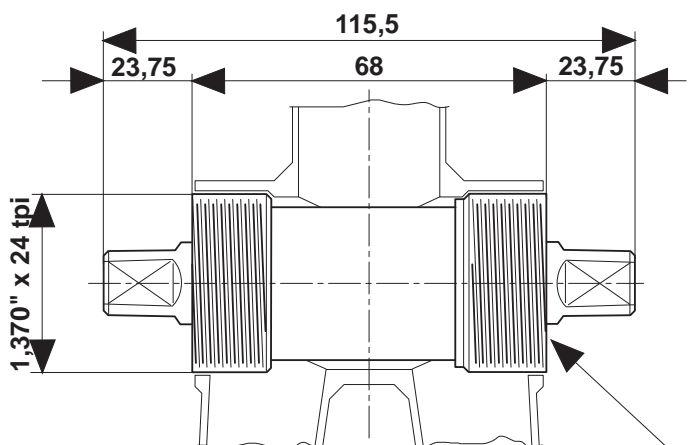

Campagnolo tool: 7130036  
Tightening torque: 70 N.m - 51,66 lb.ft

RACING T		ITA. threading
model	weight	spindle length
RACING T	296 g.	115,5mm

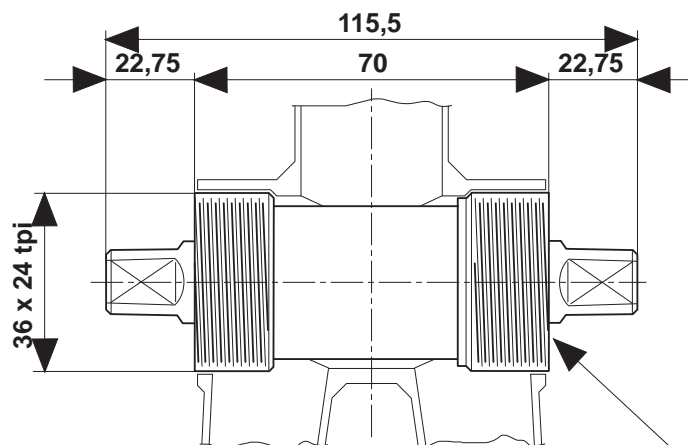

Campagnolo tool: 7130036  
Tightening torque: 70 N.m - 51,66 lb.ft

# BOTTOM BRACKETS

## *Veloce, Veloce T*

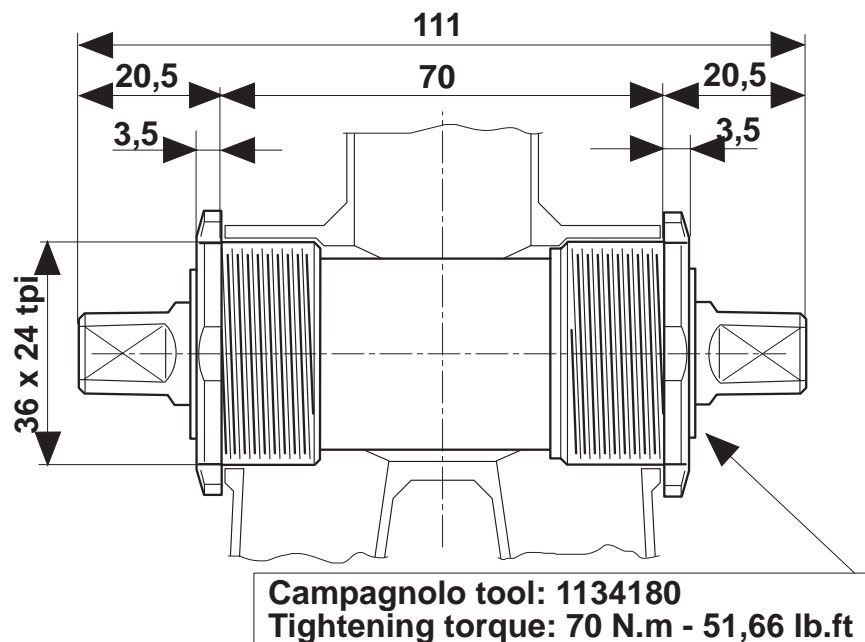
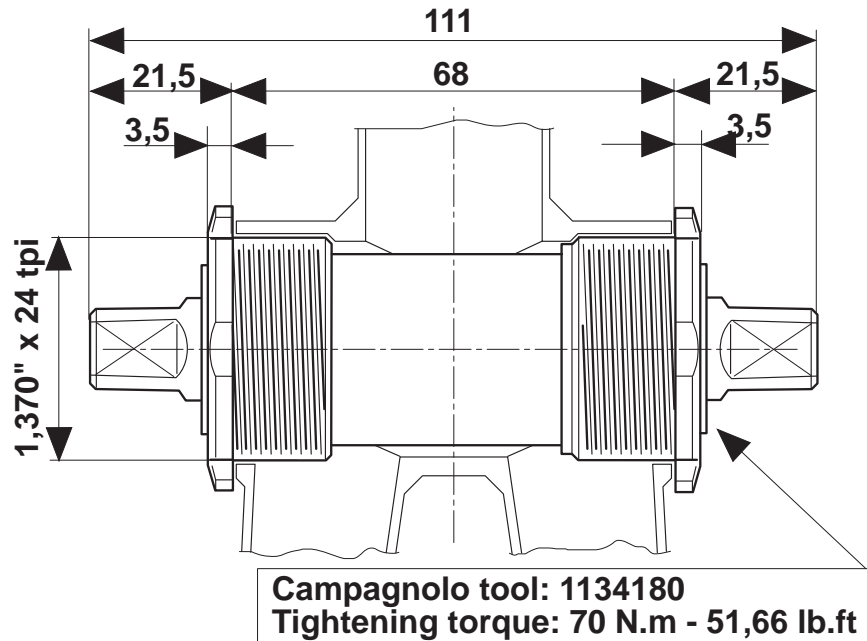

# BOTTOM BRACKETS

## *Mirage, Avanti, Mirage T*

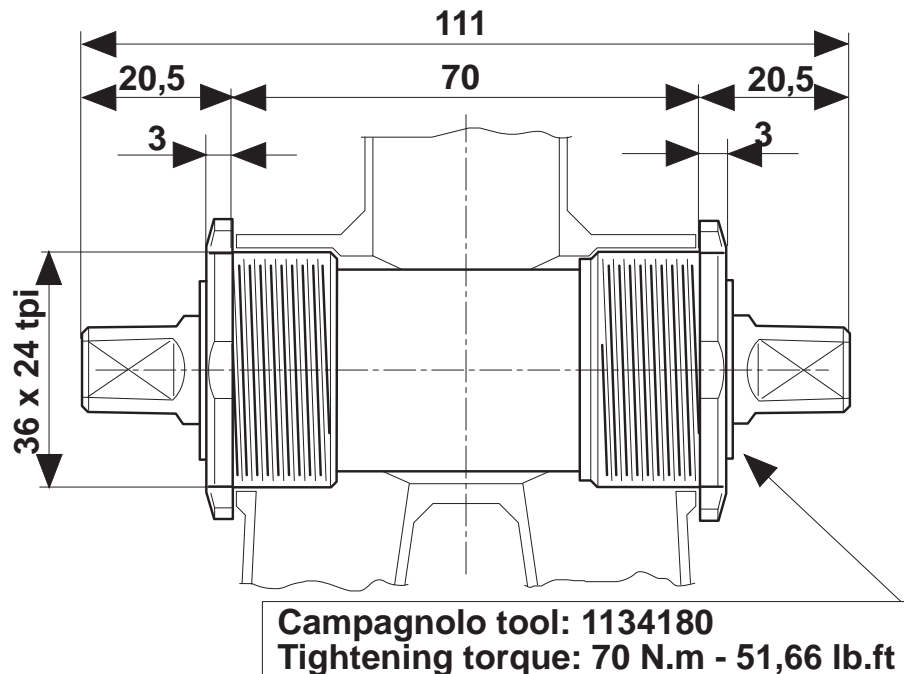
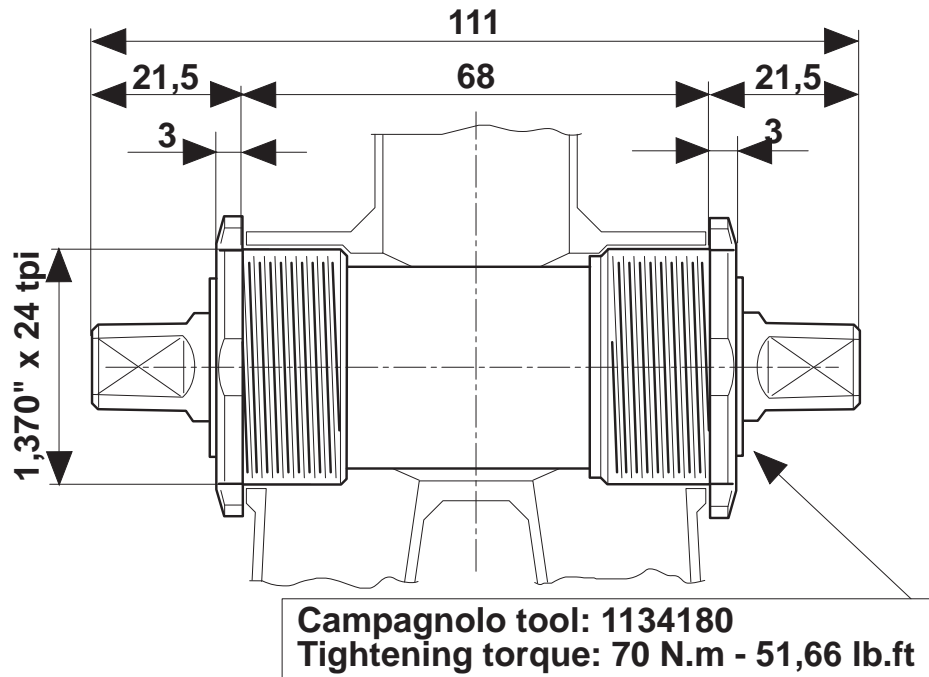

# BOTTOM BRACKETS

## *Veloce T, Mirage T*

### *For seat tube 32mm or geater*

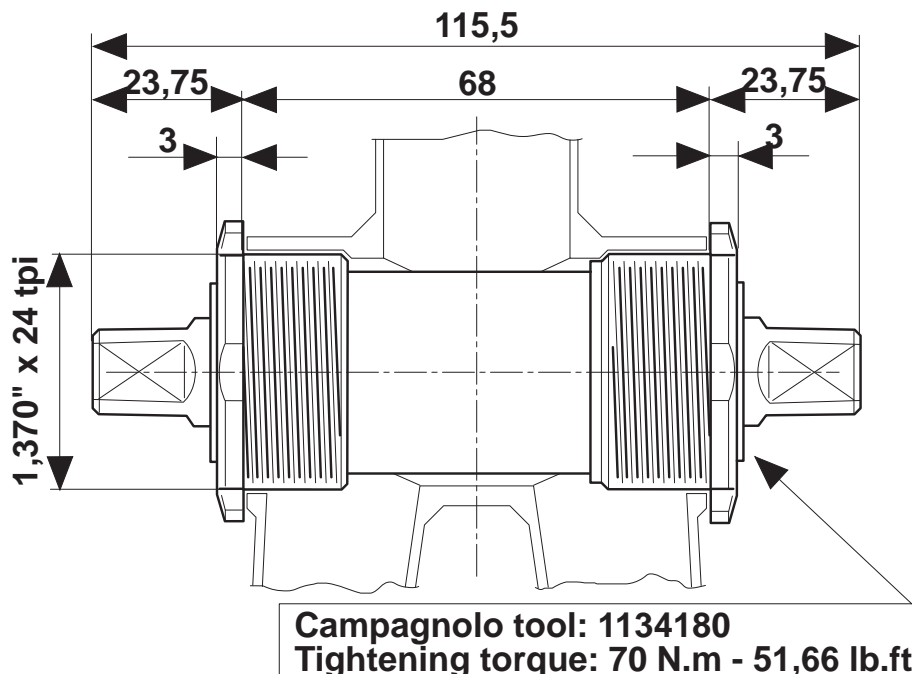
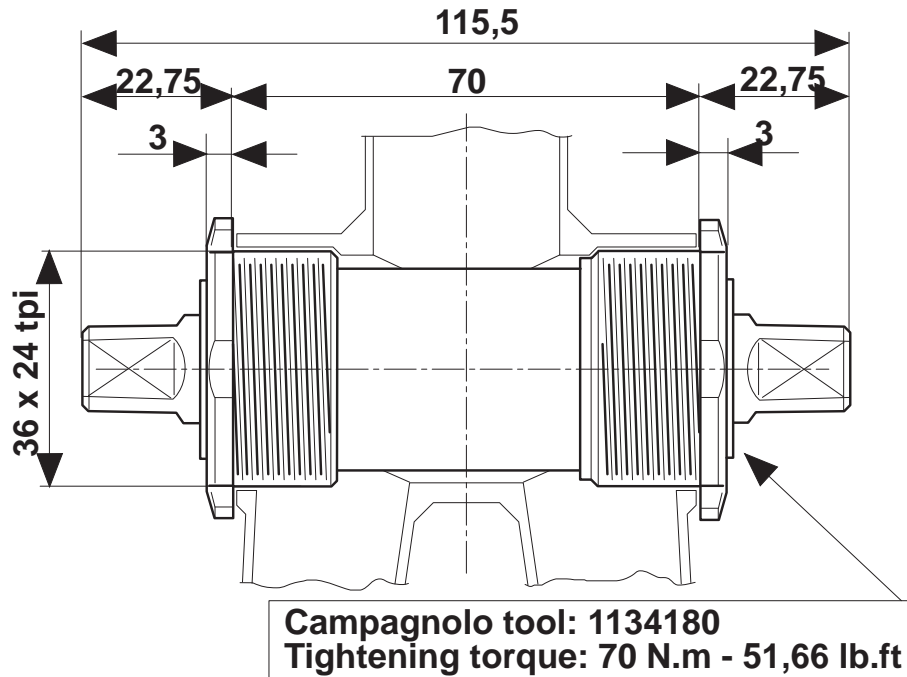



# CRANKSETS

*Record, Chorus, Athena, Veloce,  
Mirage, Avanti*

**Allen key 5mm**  
**Tightening torque:**  
**6 N.m. / 4.4 lb.ft.**



# CRANK SETS

## *Racing T, Veloce T, Mirage T*

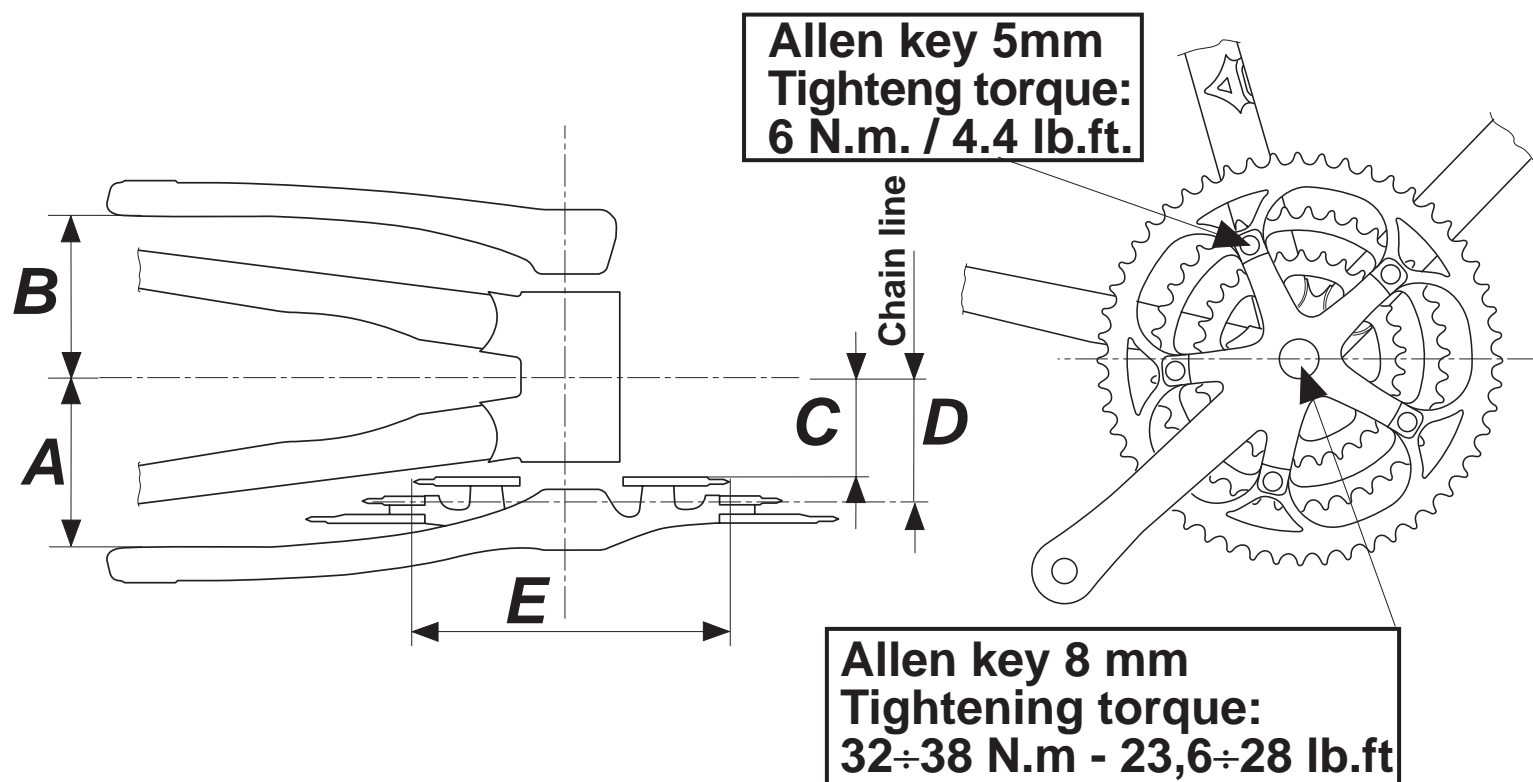

<i>model</i>	<i>A</i>	<i>B</i>	<i>C</i>	<i>D</i>	<i>E</i>	<b>111mm Axle</b>
<i>Racing T</i>	65.5	65.5	35.5	45	134	
<i>Veloce T</i>	65.5	65.5	35.5	45	134	
<i>Mirage T</i>	65.5	65.5	35.5	45	134	

# FRONT DERAILLEURS

## *Braze on*

*Record, Chorus, Veloce  
Mirage*

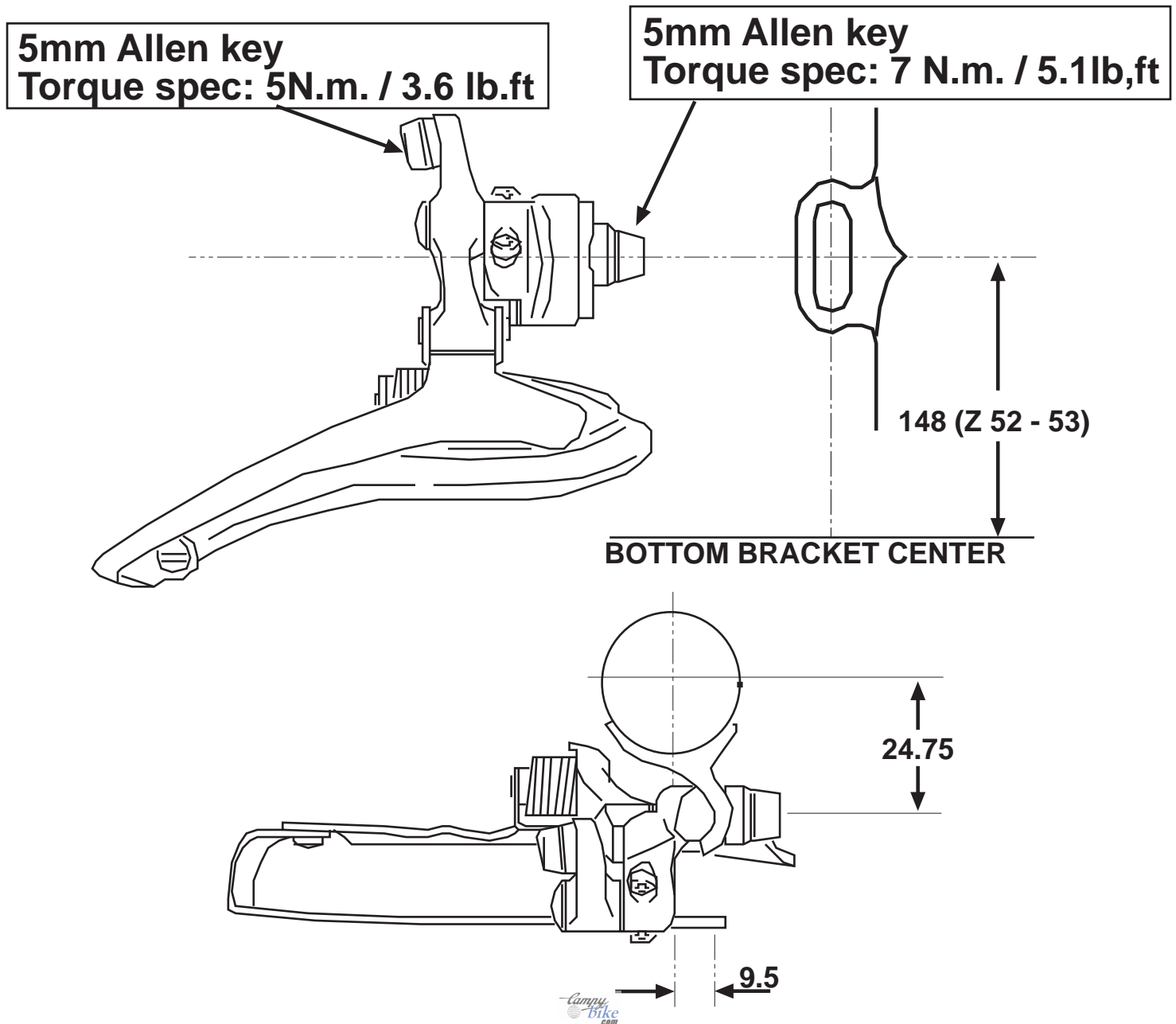

# FRONT DERAILLEUR

## *Clamp on*

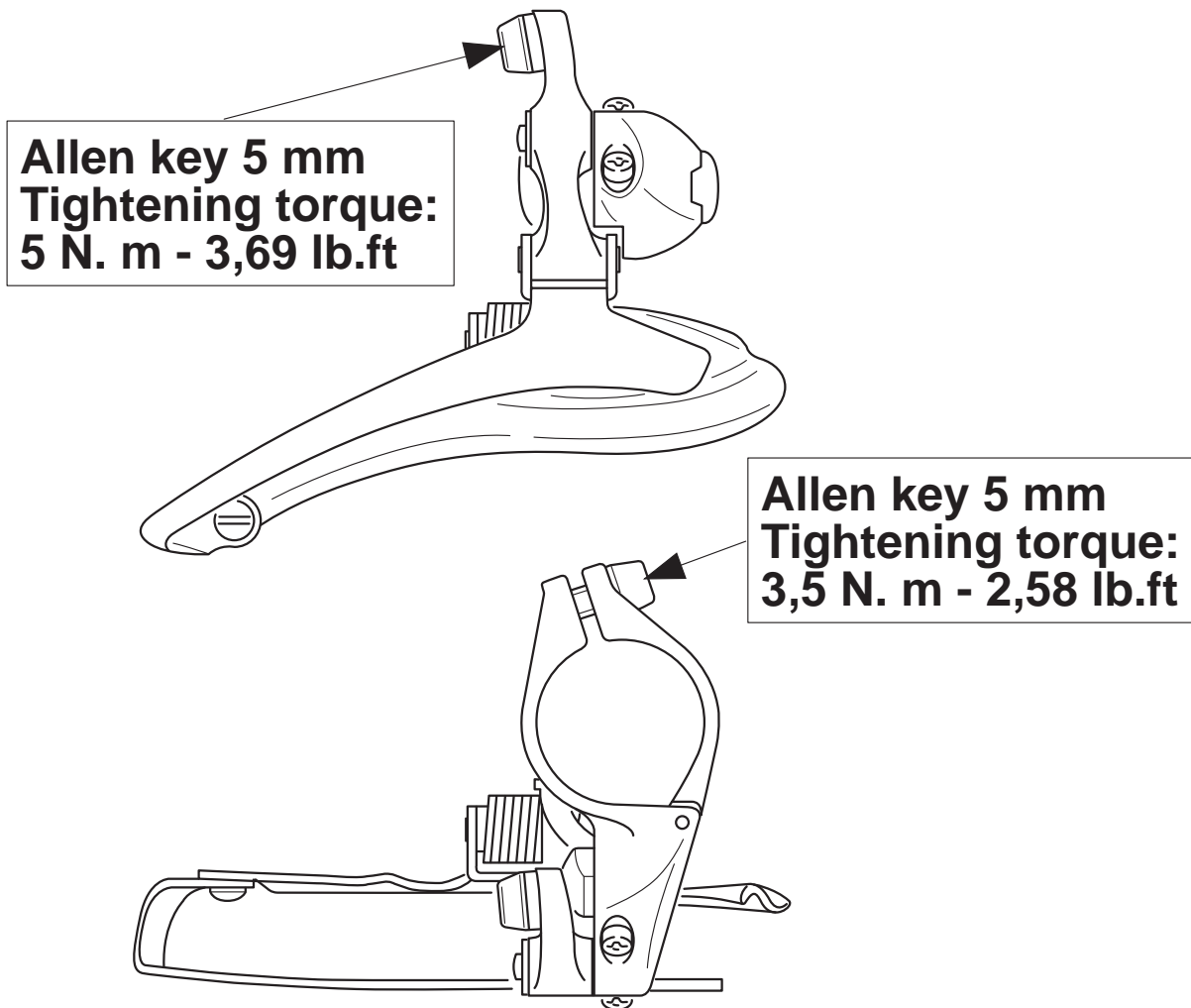

model	size available
<b><i>Record</i></b>	28.6, 32, 35mm
<b><i>Chorus</i></b>	28.6, 32, 35mm
<b><i>Veloce</i></b>	28.6, 32 mm
<b><i>Mirage</i></b>	28.6, 32 mm

# FRONT DERAILLEUR

## *Braze on, Triple*

*Racing T, Veloce T, Mirage T*

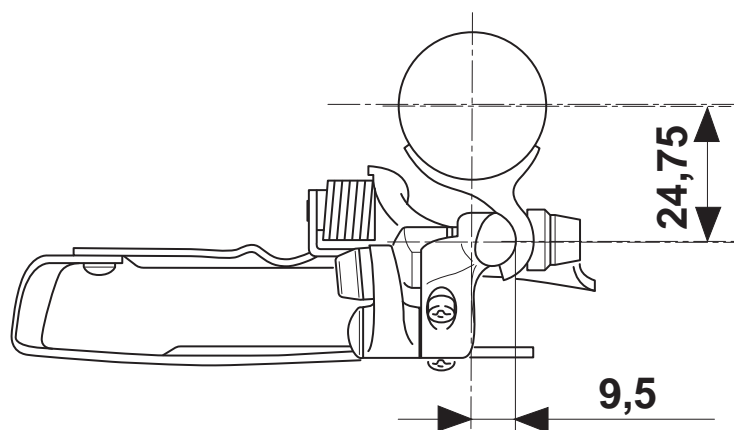
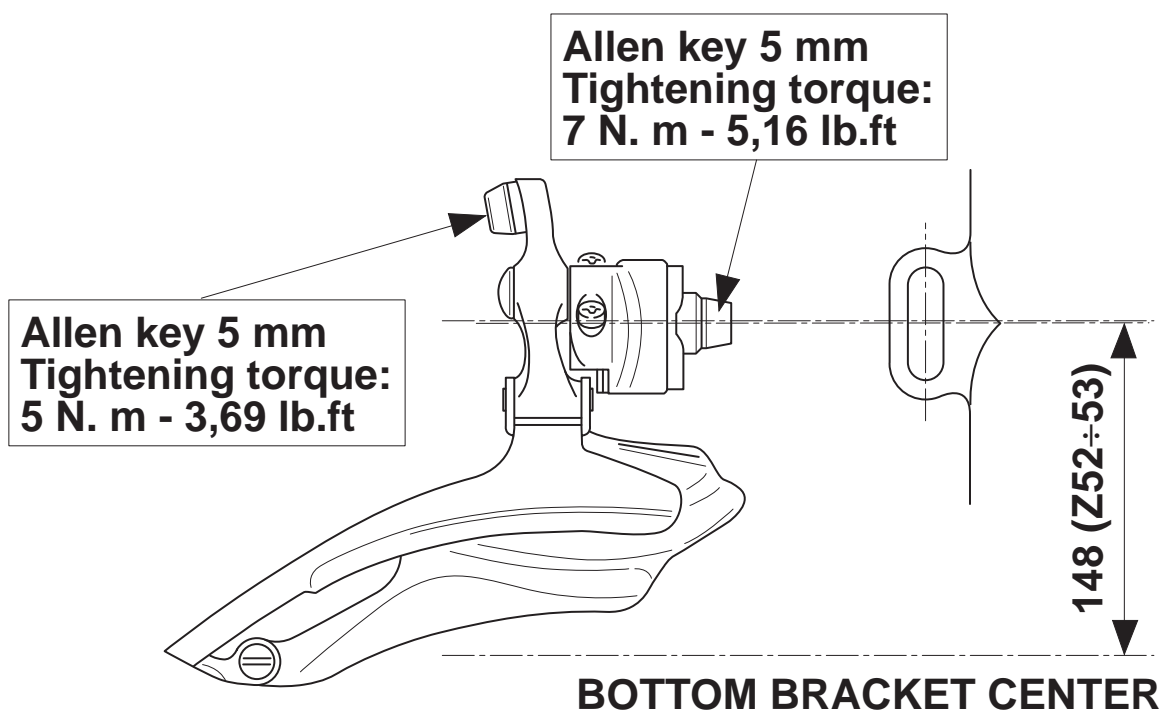

# FRONT DERAILLEUR

## *Clamp on, Triple*

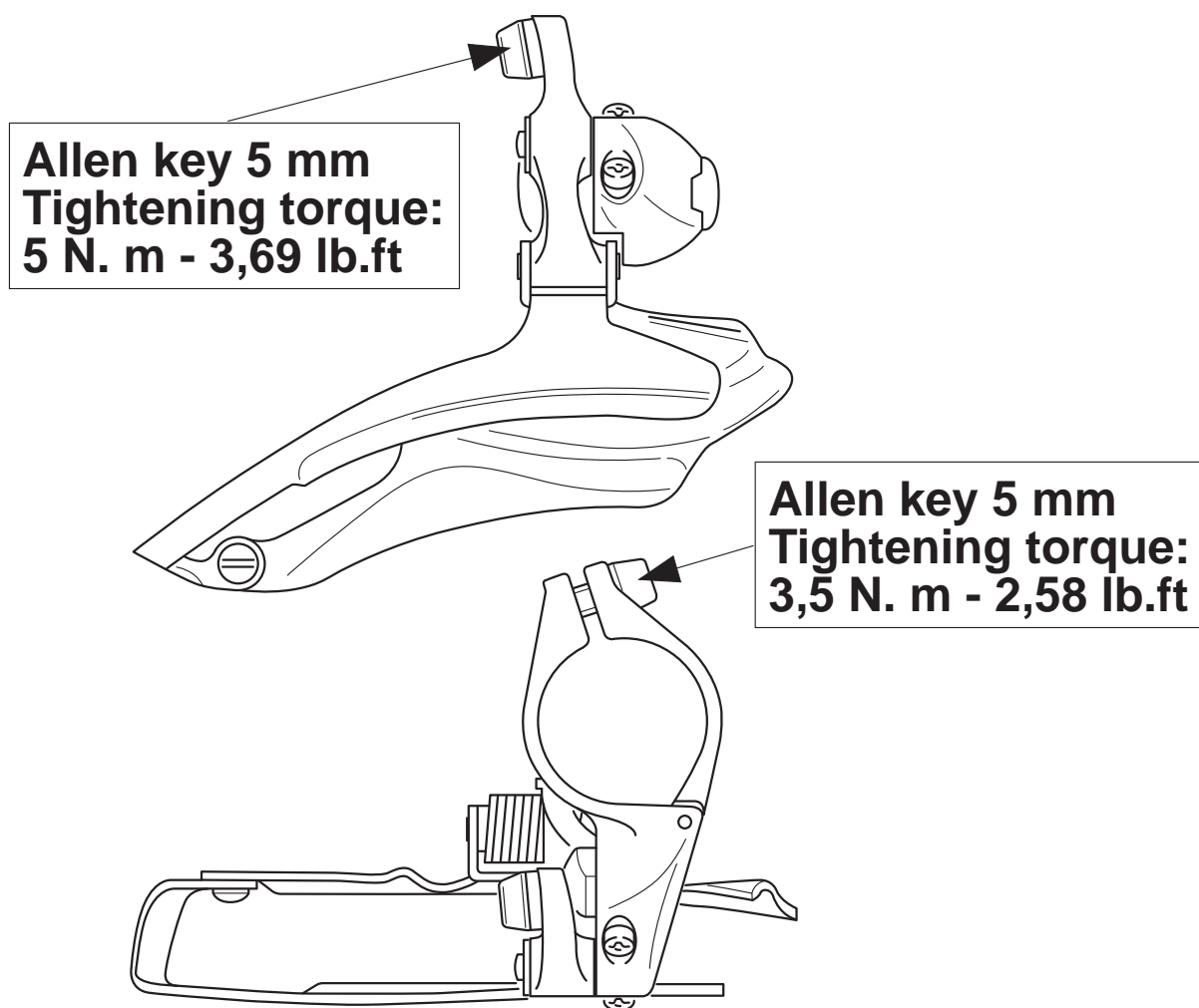

model	size available
<i>Racing T</i>	28.6, 32, 35mm
<i>Veloce T</i>	28.6, 32mm
<i>Mirage T</i>	28.6, 32mm

# REAR DERAILLEURS

Allen key 5 mm  
Tightening torque:  
15 N. m - 11,07 lb.ft

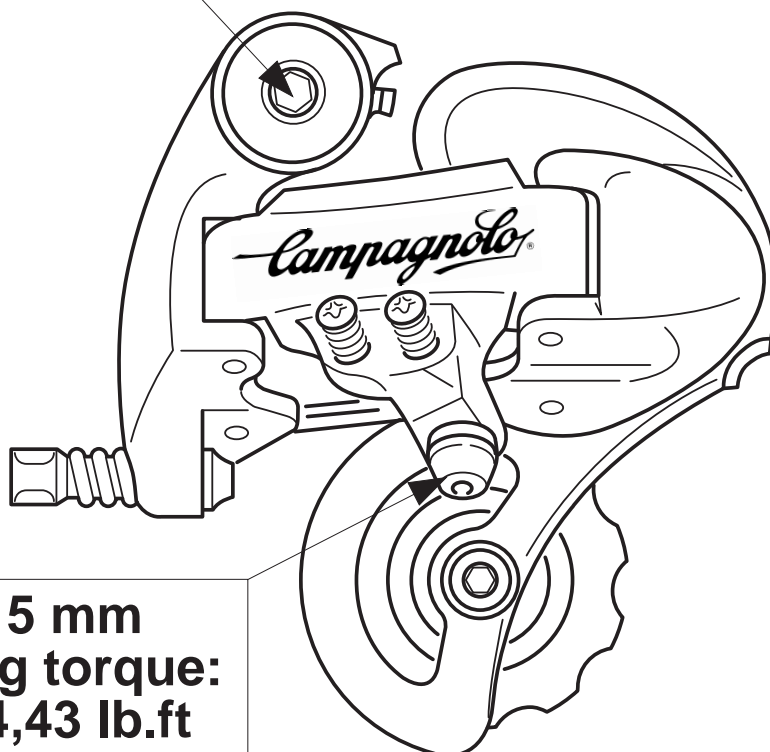

Allen key 5 mm  
Tightening torque:  
6 N. m - 4,43 lb.ft

model	max cog	capacity
<i>Record</i>	26t	27t
<i>Chorus</i>	26t	27t
<i>Athena</i>	26t	27t
<i>Veloce</i>	28t	27t
<i>Mirage</i>	28t	27t
<i>Avanti</i>	28t	26t

# REAR DERAILLEURS

## *Triple*

Allen key 5 mm  
Tightening torque:  
15 N. m - 11,07 lb.ft

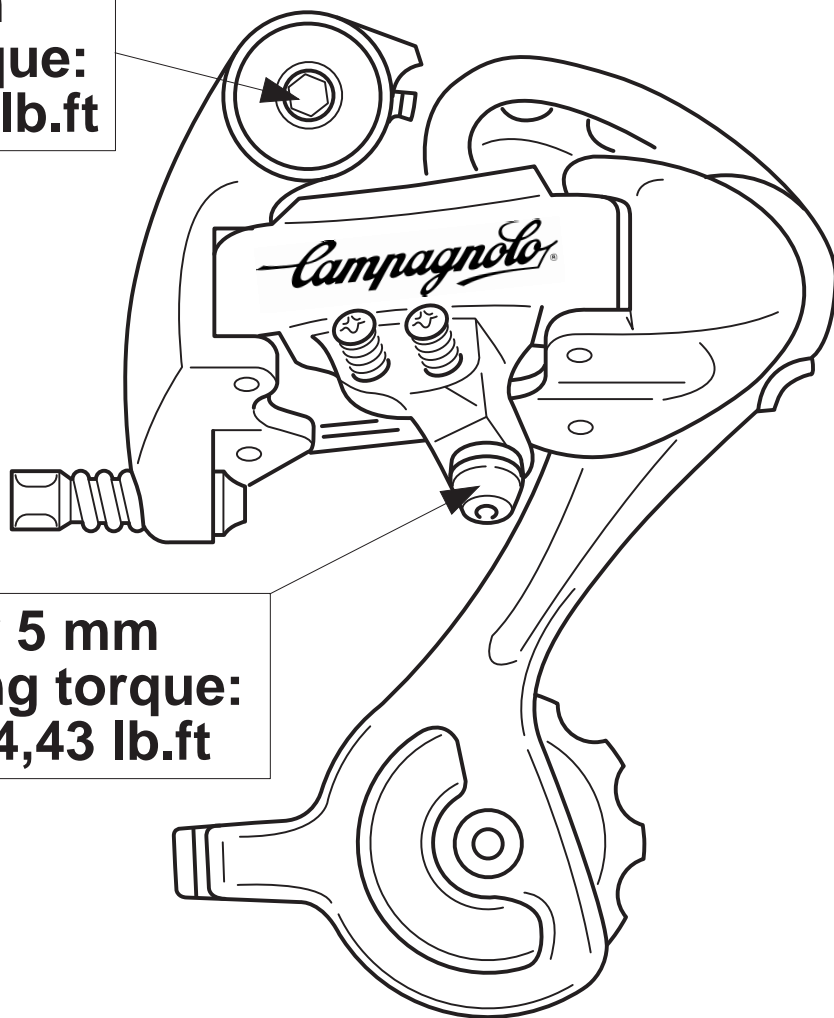

Allen key 5 mm  
Tightening torque:  
6 N. m - 4,43 lb.ft

model	max cog	capacity
<i>Racing T</i>	28t	37t
<i>Veloce T</i>	28t	37t
<i>Mirage T</i>	28t	37t
<i>Avanti T</i>	28t	37t



# OVERSIZE HUBS

## *Record, Chorus*

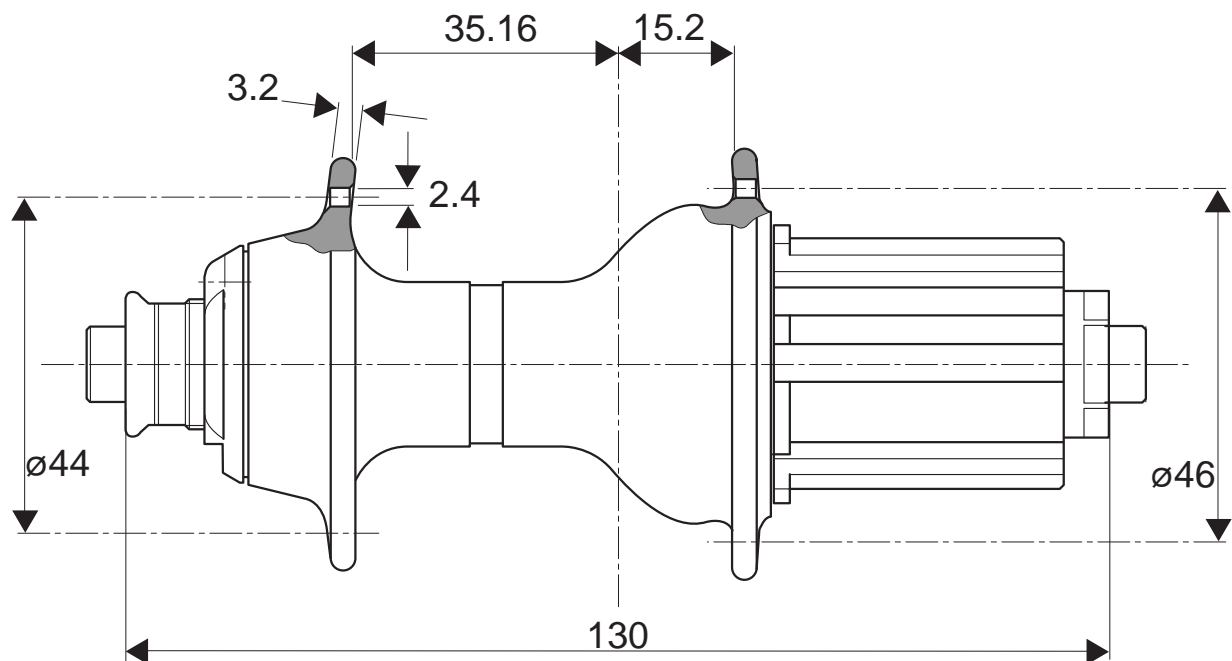
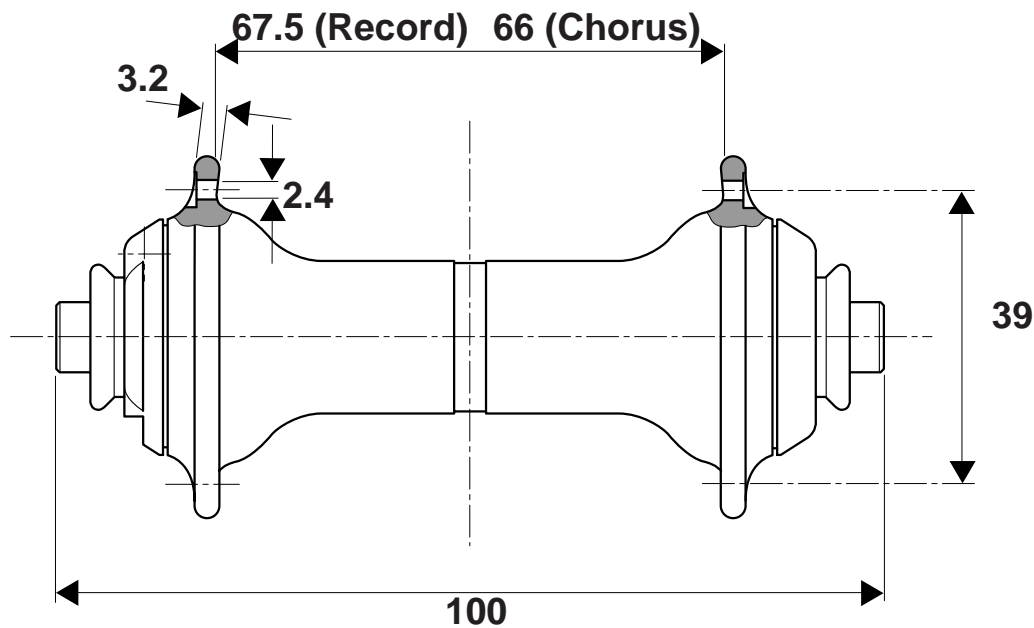

# FRONT HUBS

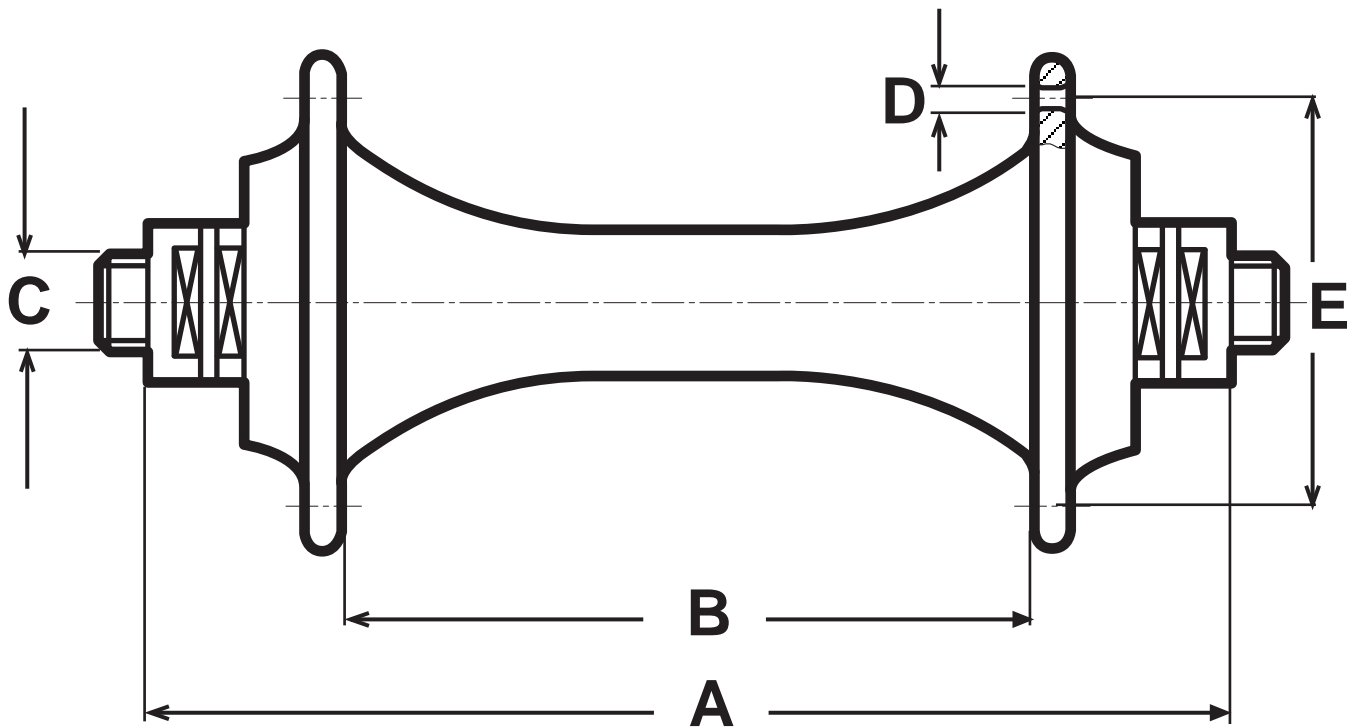

model	A	B	C	D	E
<b><i>Athena</i></b>	<b>100</b>	<b>65</b>	<b>9</b>	<b>2.6</b>	<b>38.5</b>
<b><i>Veloce</i></b>	<b>100</b>	<b>65</b>	<b>9</b>	<b>2.6</b>	<b>38.5</b>
<b><i>Mirage</i></b>	<b>100</b>	<b>65</b>	<b>9</b>	<b>2.6</b>	<b>38.5</b>
<b><i>Avanti</i></b>	<b>100</b>	<b>64</b>	<b>9</b>	<b>2.7</b>	<b>40</b>

# REAR HUBS 9 SPEED

*Athena, Veloce, Mirage*

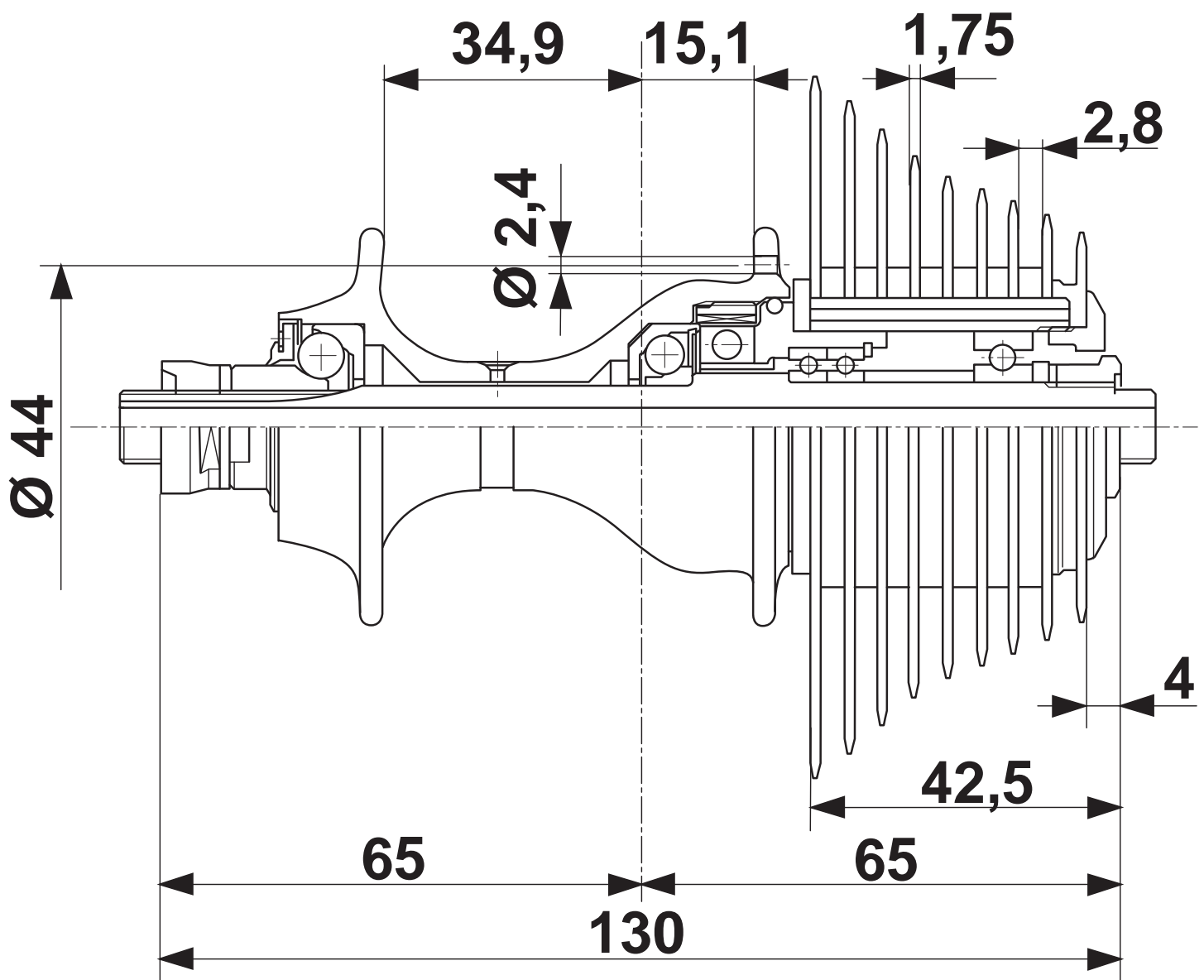

# REAR HUBS 8 SPEED

## *Avanti*

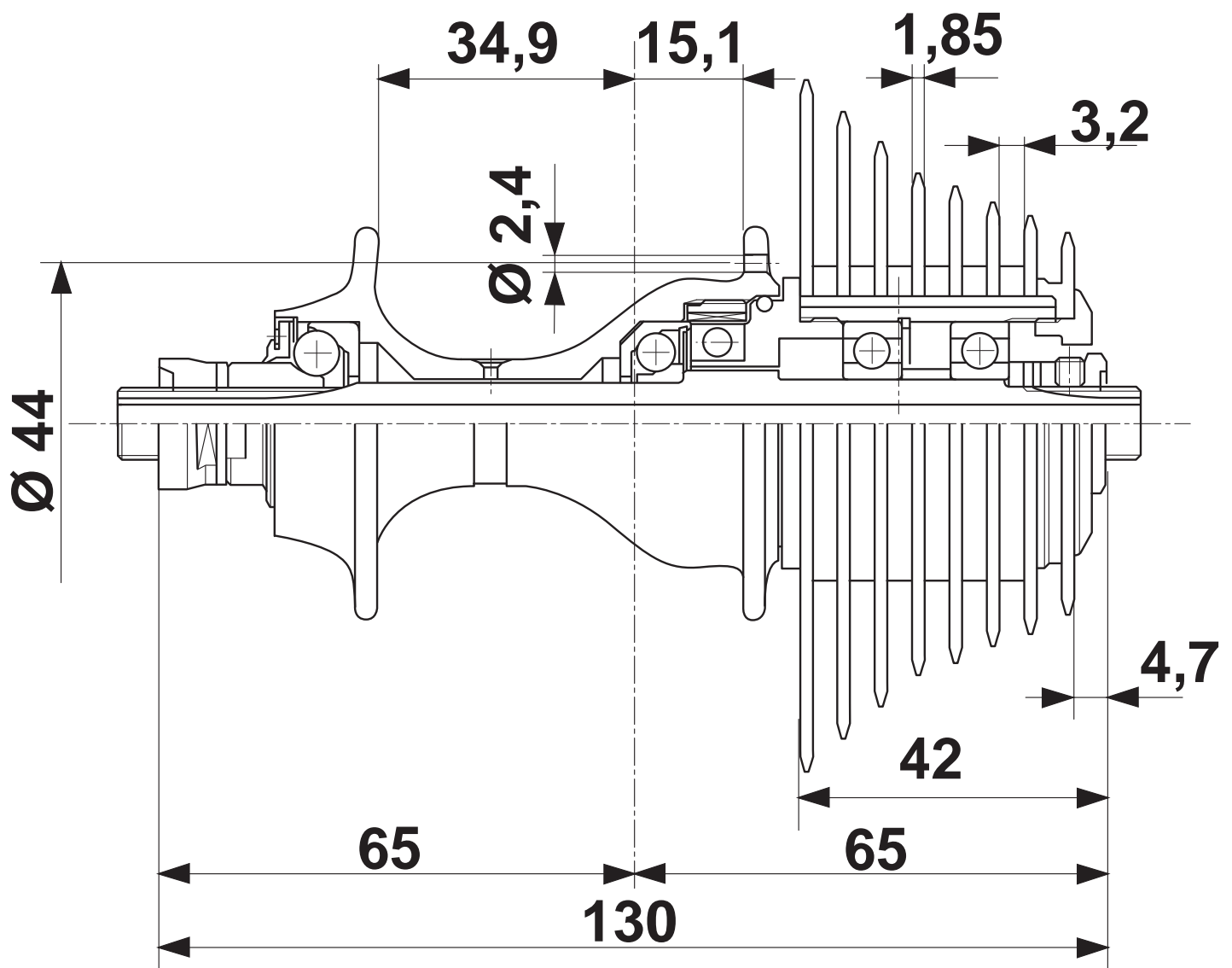

# 9 SPEED ERGOPOWER

*Record, Chorus, Athena,  
Veloce, Mirage*

Allen key 5 mm  
Tightening torque:  
8 N.m - 5,9 lb.ft

Ø 23,8 ÷ 24,2 mm

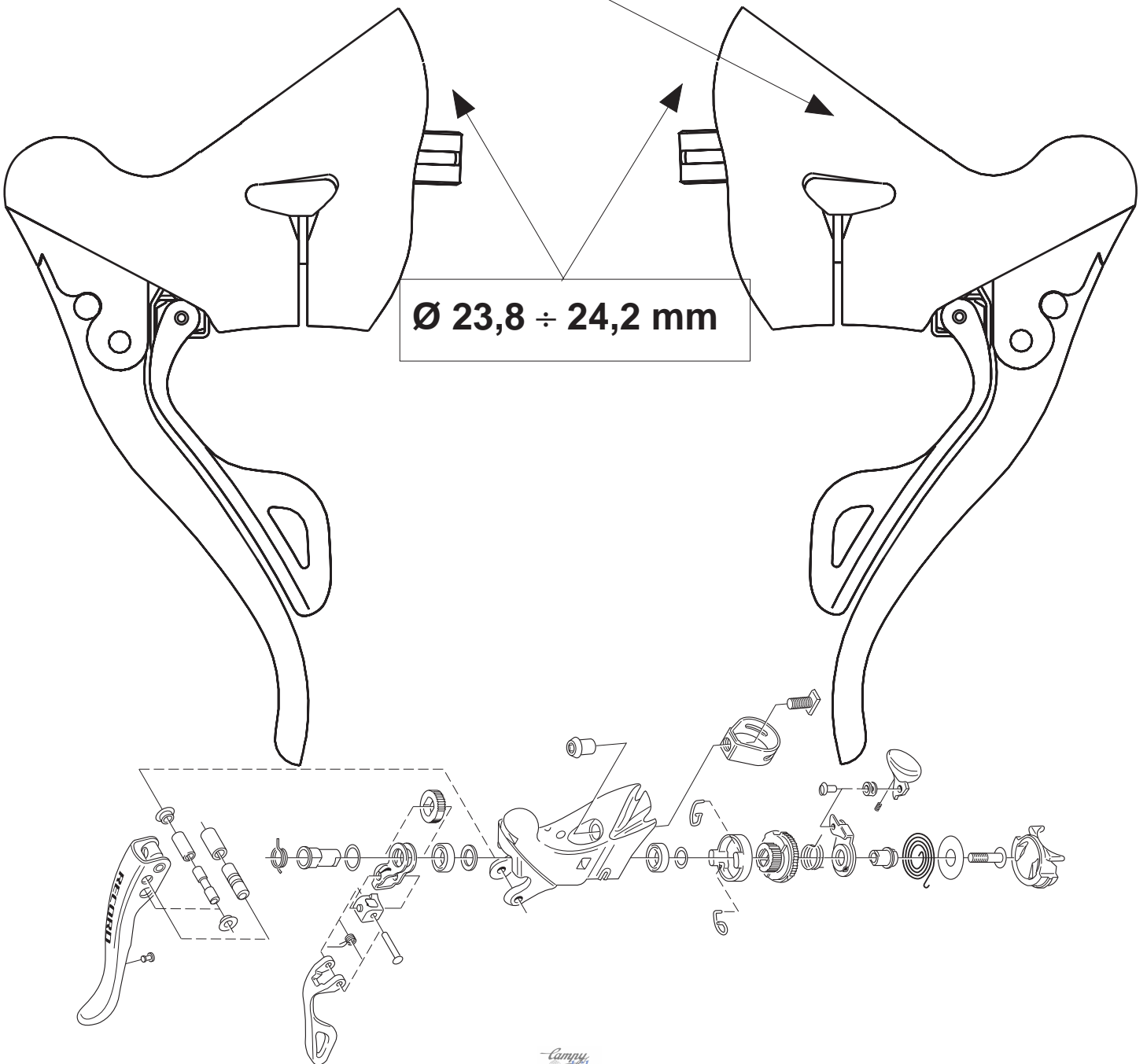

# 8 SPEED ERGOPOWER

## *Avanti*

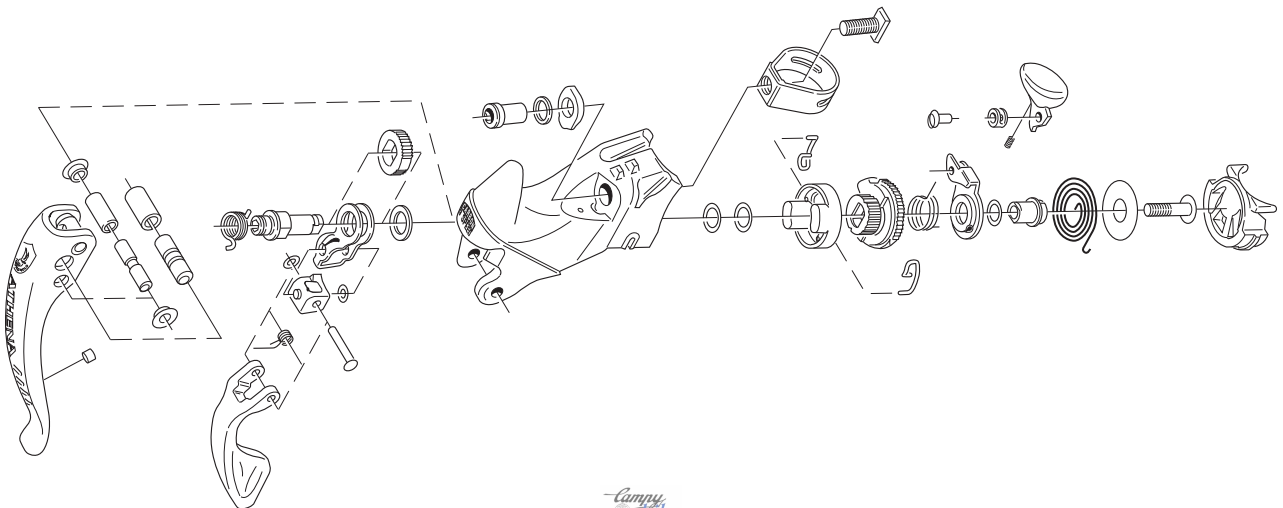
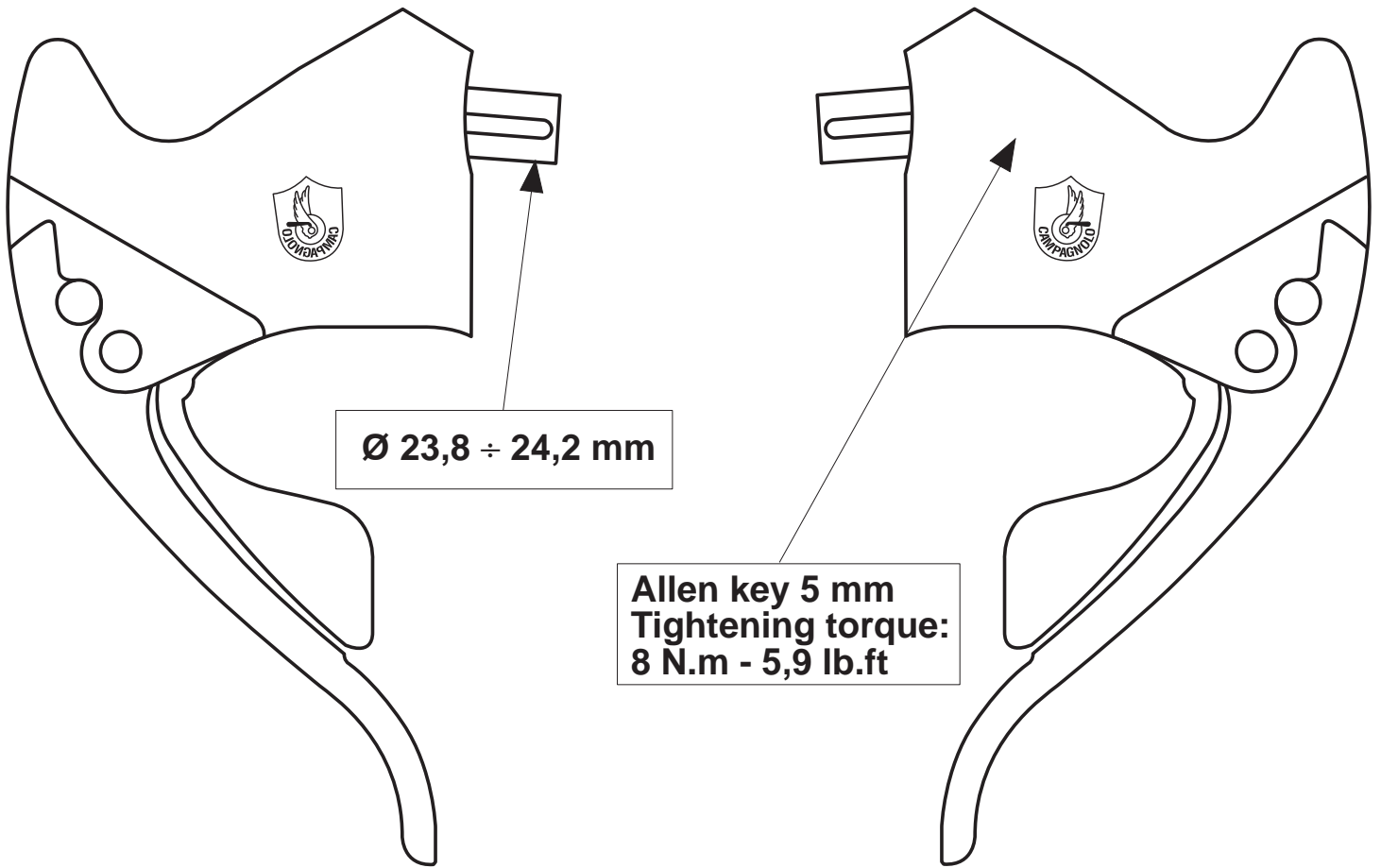

# DUAL PIVOT BRAKES

*Record, Chorus, Athena,  
Veloce, Mirage, Avanti*

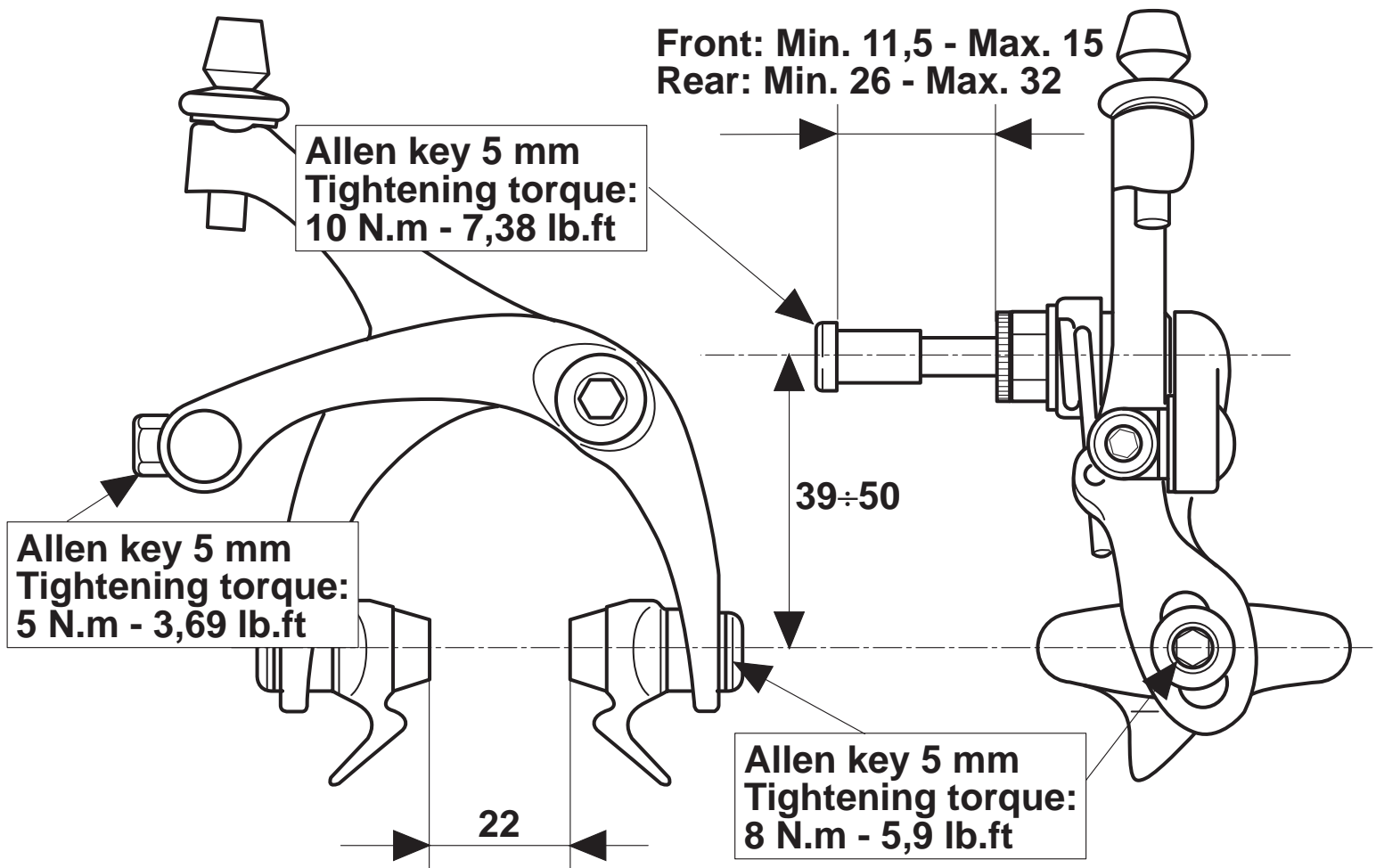

# SEAT POST

## *Record Titanium*

