

Campagnolo®

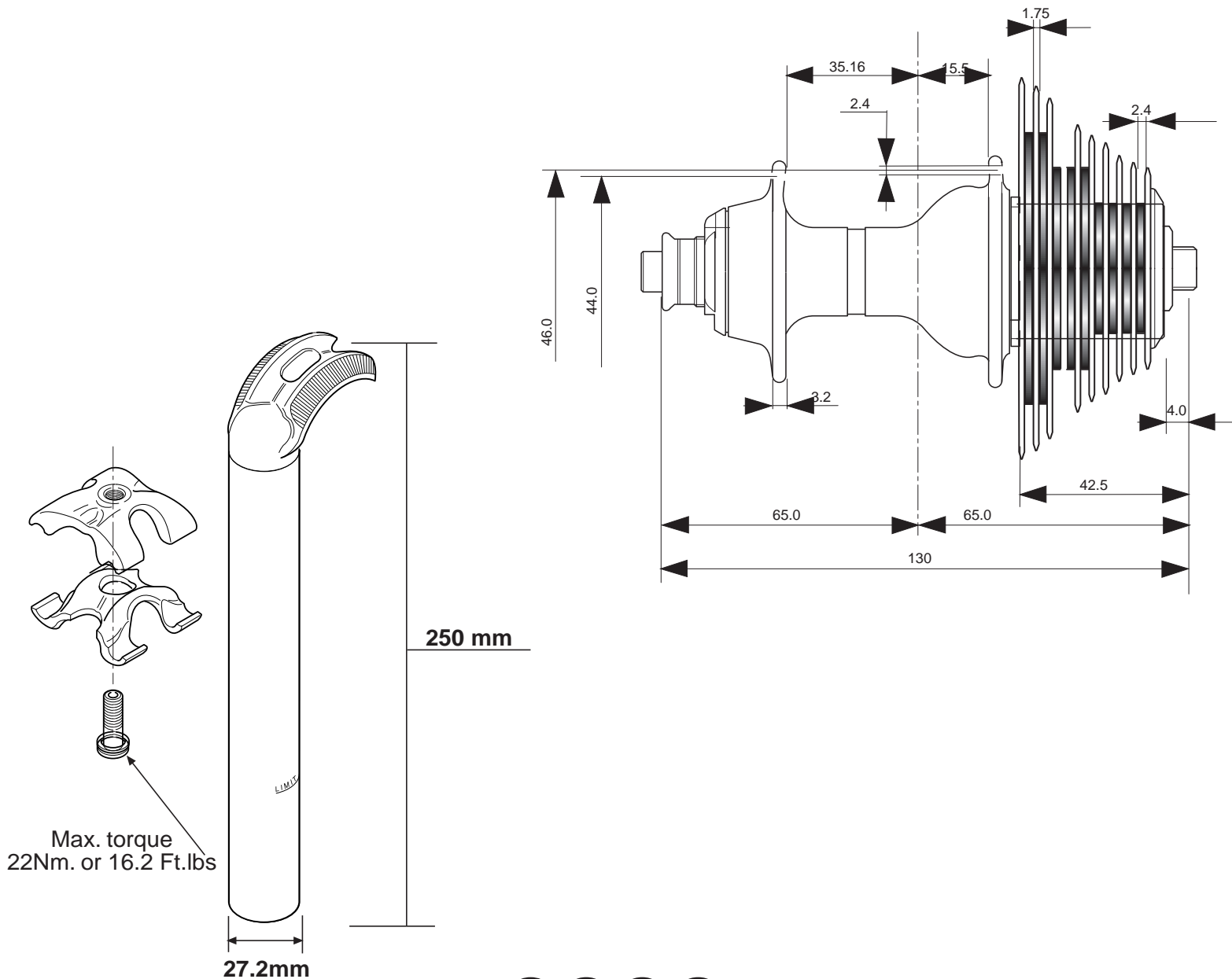

2000 Technical Specifications

HEADSETS (Threaded)

RECORD, CHORUS

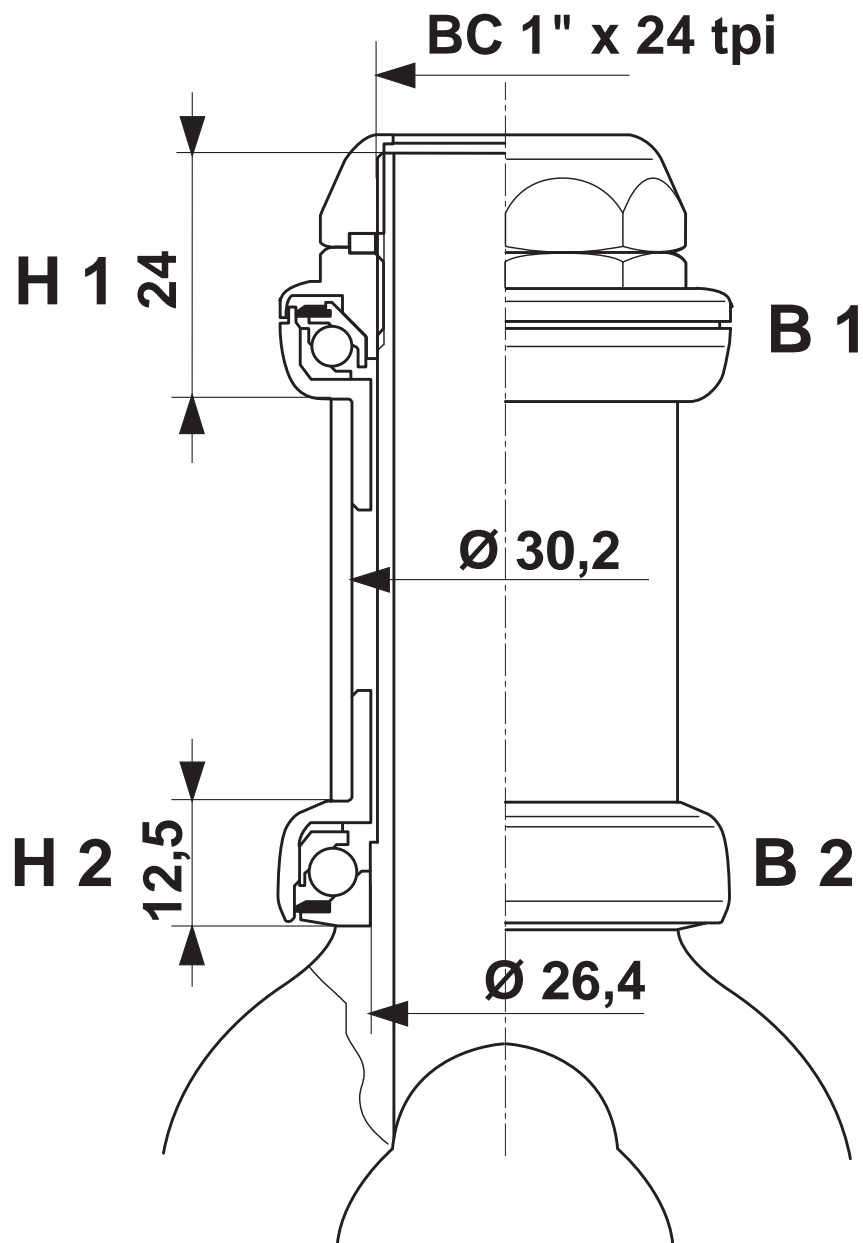

2000 threaded headsets stack heights

model	item code	B 1	B 2	H 1	H 2	H 1 + H 2
RECORD	HS00-RE	5/32"	3/16"	24mm	12.5 mm	36.5 mm
CHORUS	HS00-CH	5/32"	3/16"	24mm	12.5 mm	36.5 mm

HEADSETS (THREADLESS)

RECORD, CHORUS

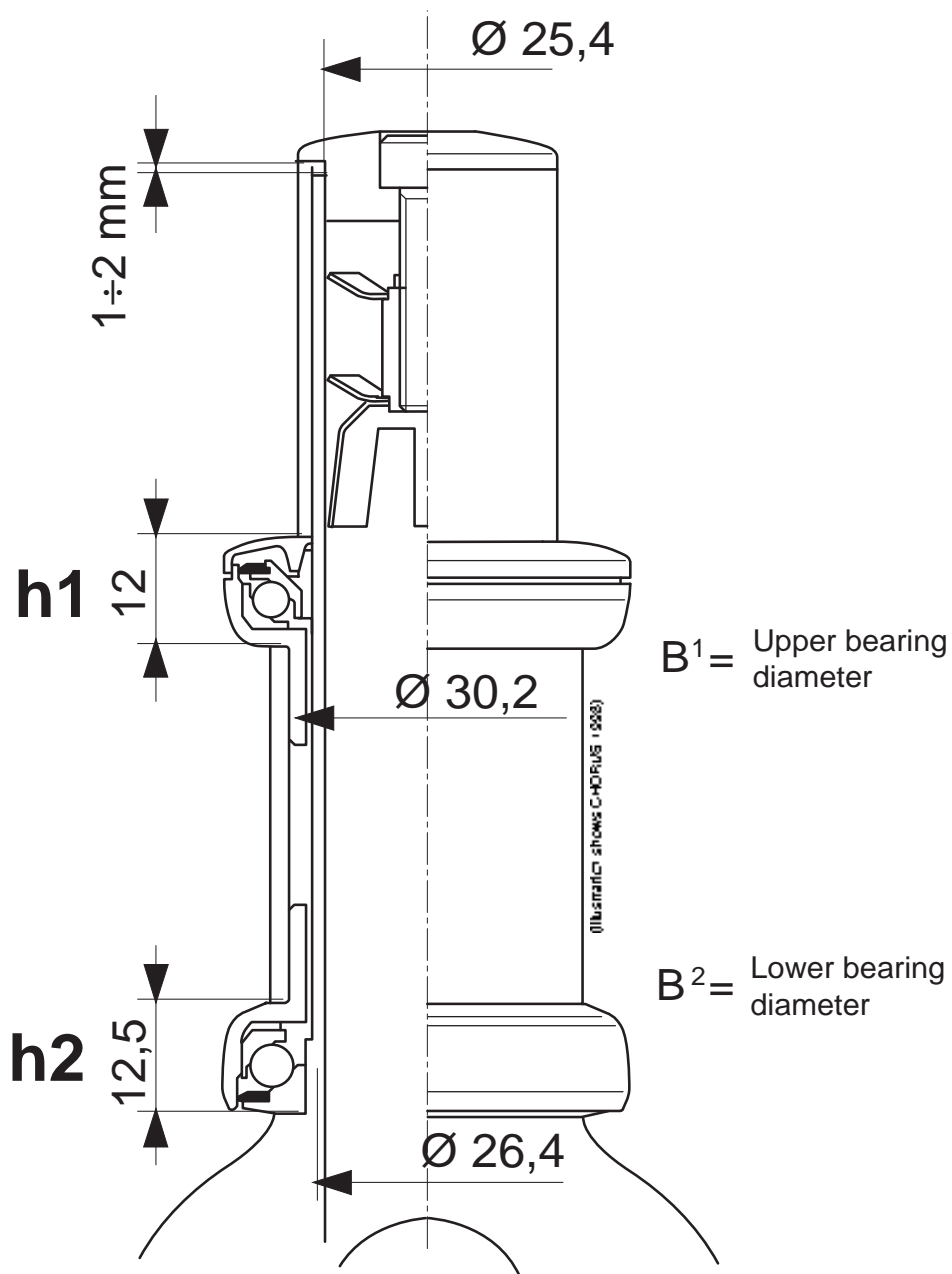

2000 Headsets (threadless) stack heights

model	item code	B1	B2	h1	h2	h1+h2
RECORD	HS00-RETH	5/32"!	3/16"!	12mm	12.5 mm	24.5 mm
CHORUS	HS00-CHTH	5/32"!	3/16"!	12mm	12.5 mm	24.5 mm

! = make sure to install smaller \varnothing bearings (5/32") on top and larger \varnothing bearings at bottom of HS

RECORD

Override Threadless Headset

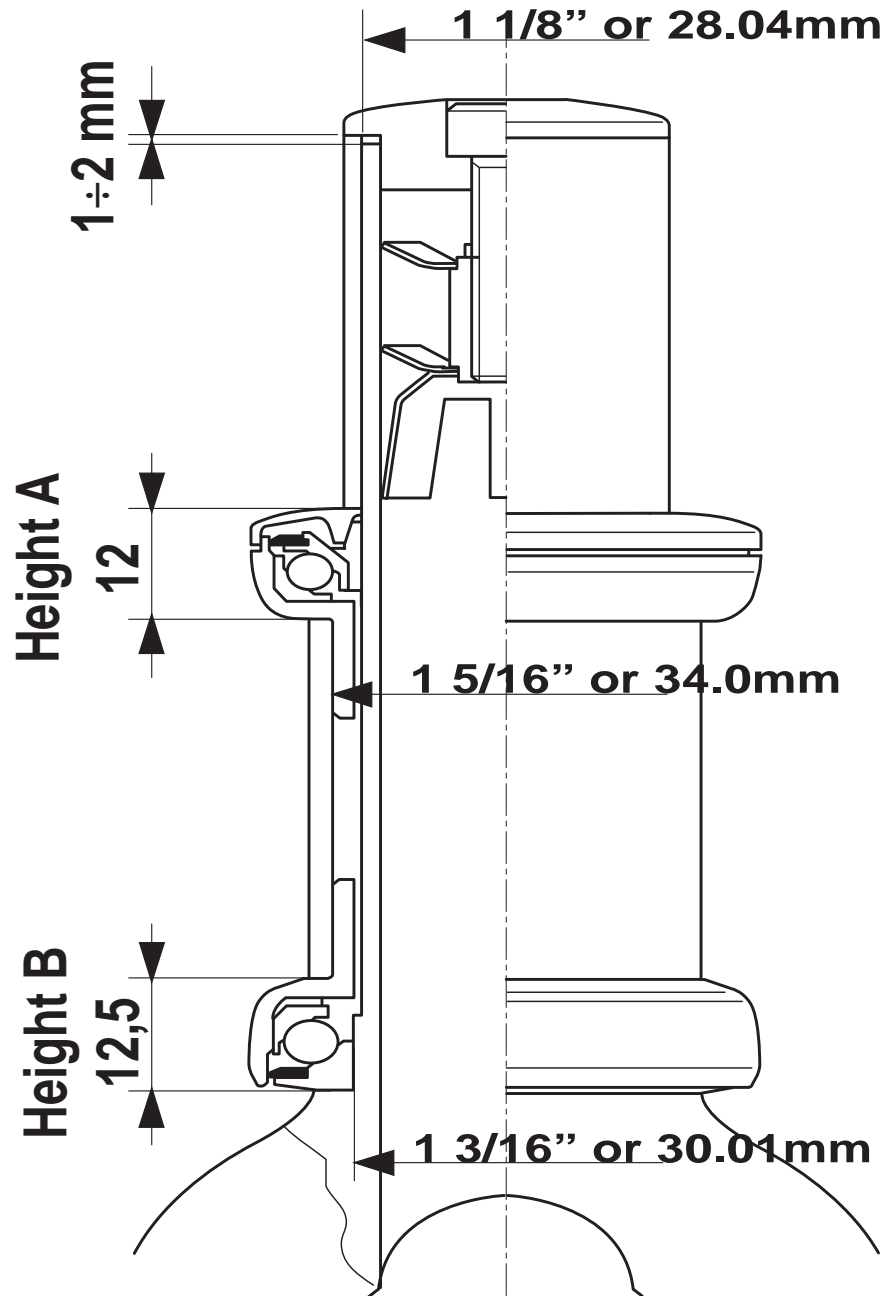

2000 Override threadless headset stack height

Model	Code	Height A	Height B	Total
RECORD	HS00-RETHOS	12.0 mm	12.5 mm	24.5 mm

BOTTOM BRACKETS

RECORD, CHORUS

RECORD

BSC. threading

item code	weight	spindle length
BB99-RE02BC	190g	102mm

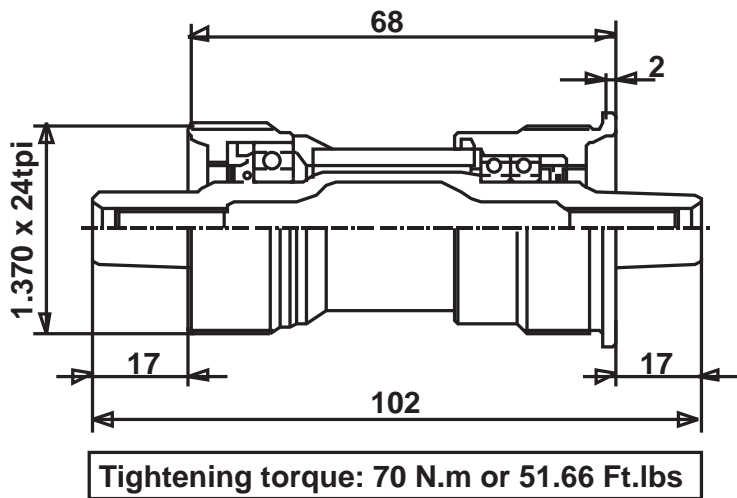

RECORD

ITA. threading

item code	weight	spindle length
BB99-RE02IT	193g	102mm

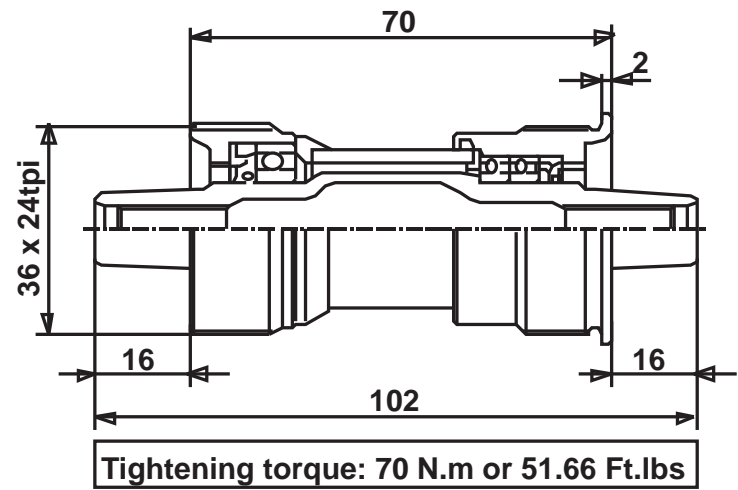

CHORUS

BSC. threading

item code	weight	spindle length
BB99-CH02BC	223g	102mm

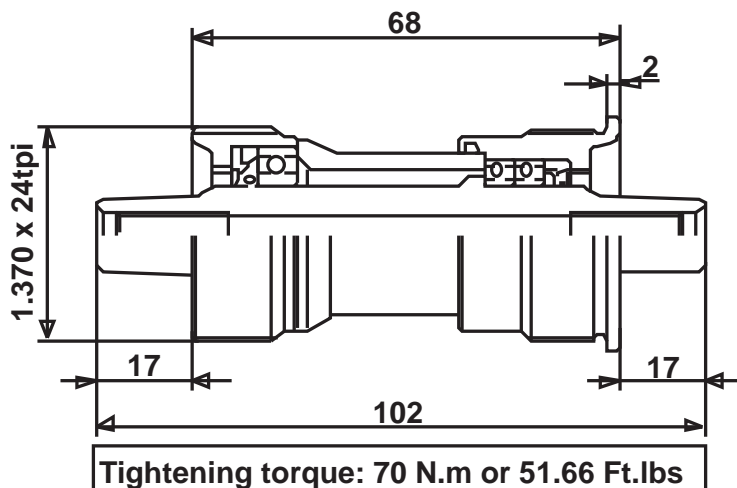

CHORUS

ITA. threading

item code	weight	spindle length
BB99-CH02IT	226g	102mm

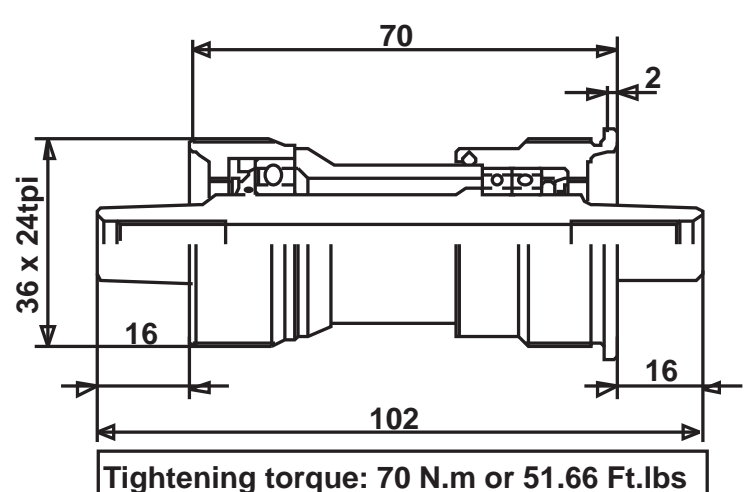

BOTTOM BRACKETS

DAYTONA, RACING T

DAYTONA & RACING T

DAYTONA AC-H & AC-S BSC. threading

item code	weight	spindle length
BB00-AS11BC	299 g.	111mm
BB00-AH11BC	288 g.	111mm

DAYTONA AC-H & AC-S ITA. threading

item code	weight	spindle length
BB00-AH11IT	288 g.	111 mm
BB00-AS11IT	299 g.	111 mm

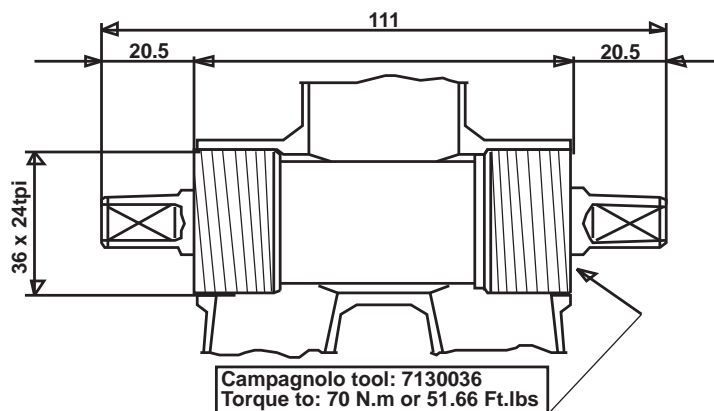
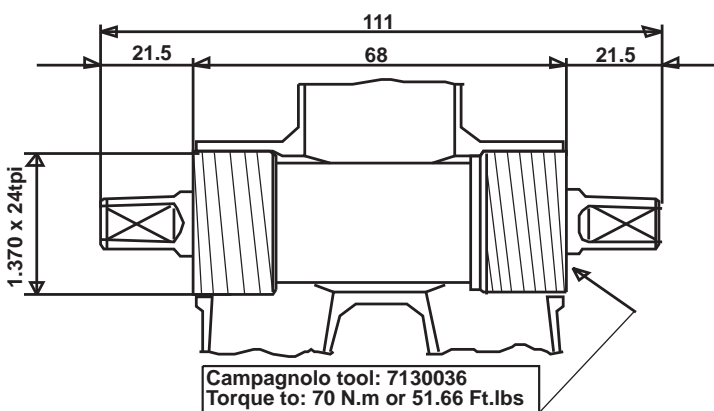

RACING T with seat-tube $\varnothing \geq 32\text{mm}$:

RACING T BSC. threading

item code	weight	spindle length
BB00-AH15BC	288 g.	115,5mm

RACING T ITA. threading

item code	weight	spindle length
BB00-AH15IT	288 g.	115,5mm

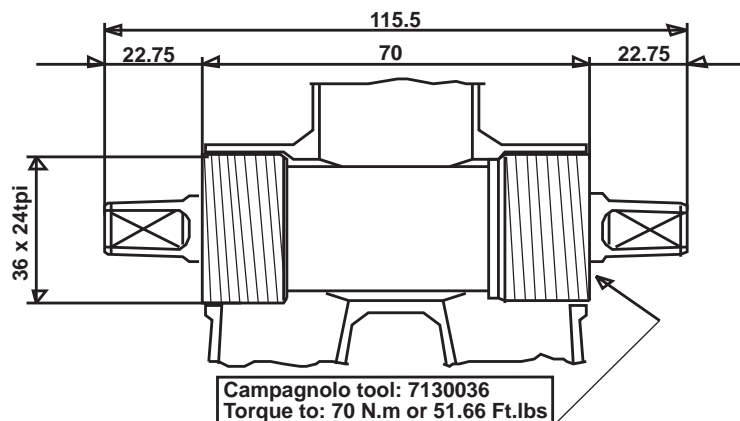
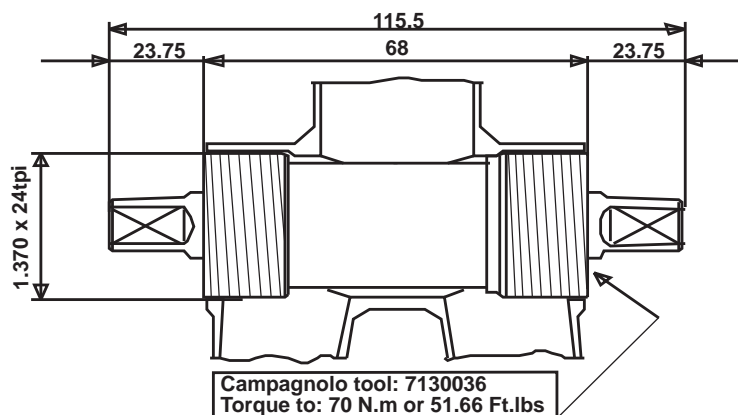

BOTTOM BRACKETS VELOCE & VELOCE TRIPLE

VELOCE

VELOCE AC-S & SC-S BSC. threading

item code	weight	spindle length
BB00-SS11BC	358 g.	111mm
BB00-AS11BC	299 g.	111 mm

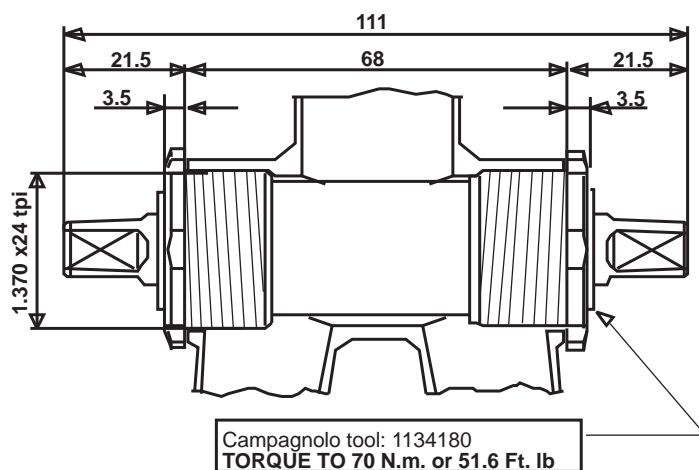

VELOCE AC-S & SC-S ITA. Threading

item code	weight	spindle length
BB00-AS11IT	299 g.	111 mm
BB00-SS11IT	358 g.	111 mm

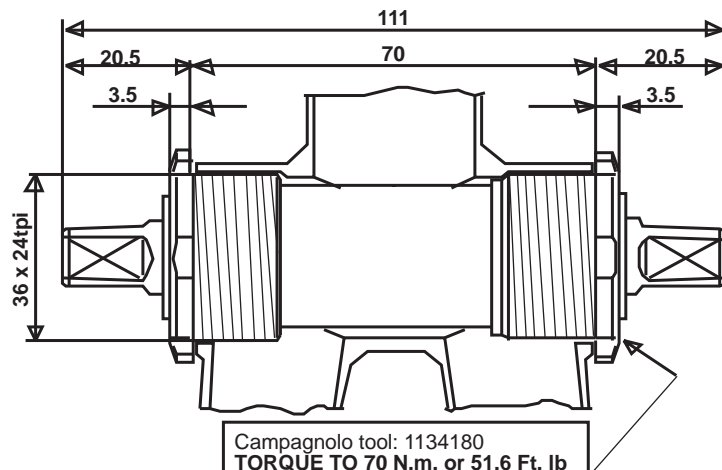

VELOCE Triple with seat-tube $\varnothing \geq 32\text{mm}$:

VELOCE Triple BSC. threading

item code	weight	spindle length
BB00-AH15BC	288 g.	115,5mm
BB00-SS15BC	358 g.	115,5mm

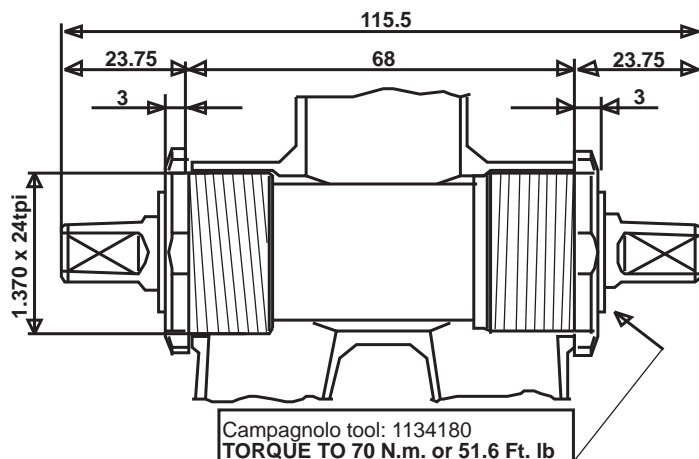

VELOCE Triple ITA. threading

item code	weight	spindle length
BB00-AH15IT	288 g.	115,5mm
BB00-SS15IT	358 g.	115,5mm

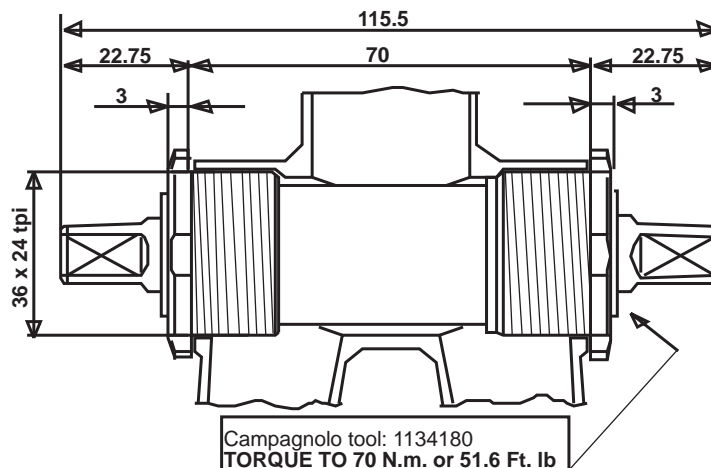

BOTTOM BRACKETS

MIRAGE & MIRAGE TRIPLE

MIRAGE, & MIRAGE Triple:

MIRAGE

BSC. threading

item code	weight	spindle length
BB00-SS11BC	348g	111mm

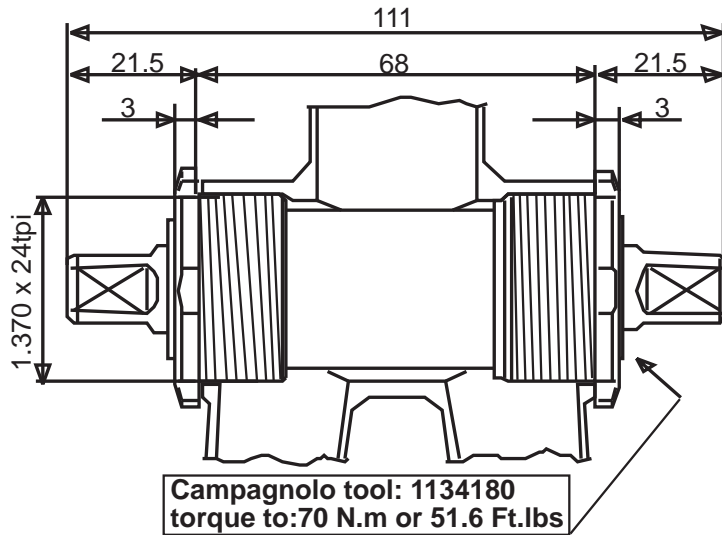

MIRAGE

ITA. Threading

item code	weight	spindle length
BB00-SS11IT	350g	111mm

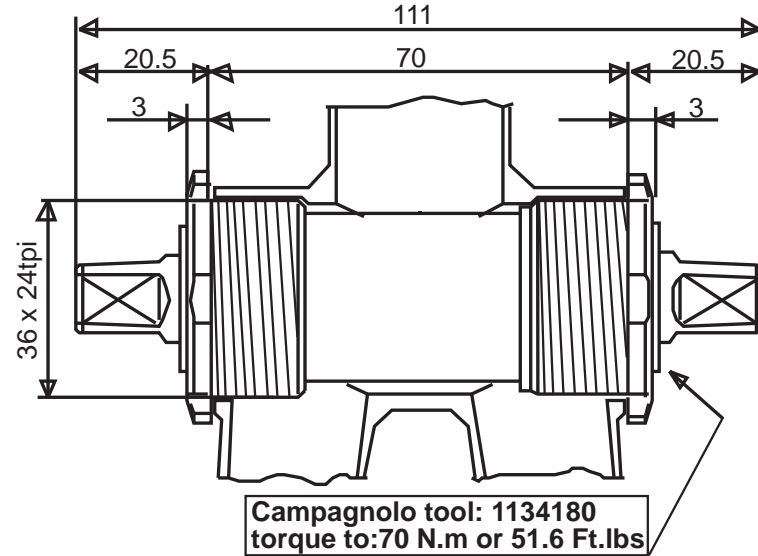

MIRAGE Triple with seat-tube $\varnothing \geq 32\text{mm}$:

MIRAGE Triple

BSC. threading

item code	weight	spindle length
BB00-SS15BC	364g	115,5mm

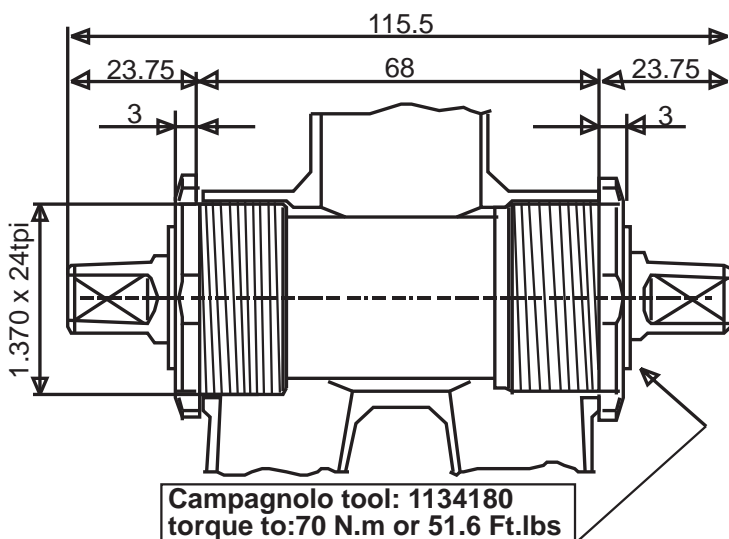

MIRAGE Triple

ITA. Threading

item code	weight	spindle length
BB00-SS15IT	364g	115,5mm

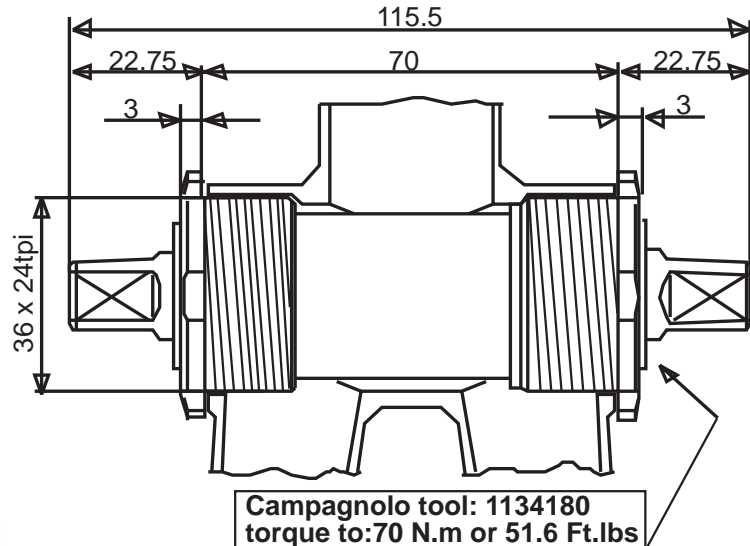

CRANKSETS

(with double chainrings)

Allen key 8 mm
Tightening torque:
32÷38 N.m - 23,6÷28 lb.ft

The use of a torque wrench is highly recommended to ensure proper crank arm assembly!
DO NOT grease BB-spindle when assembling crank arms!

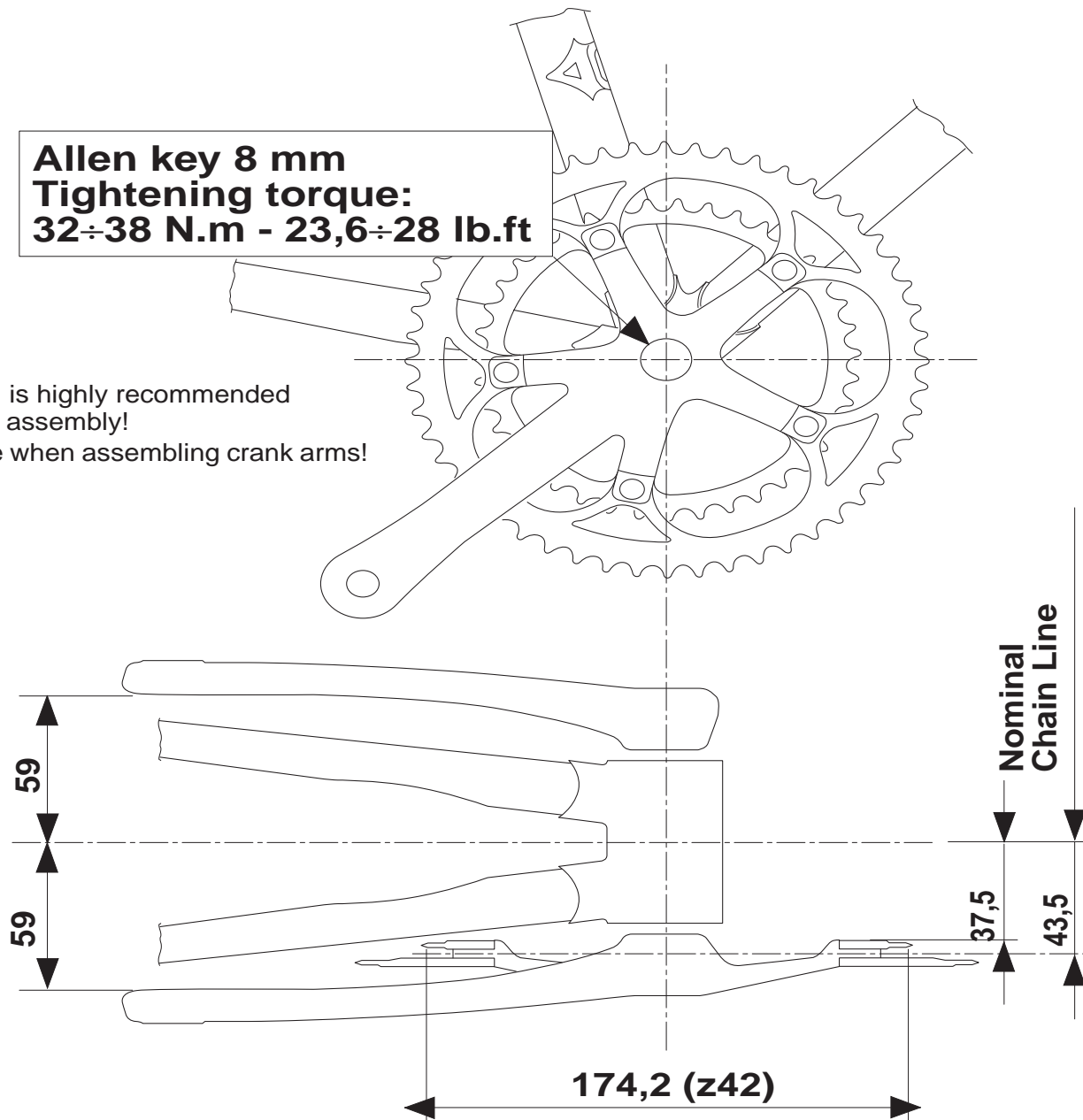

2000 CRANKSETS

model	length avail.	weight	BB spindle
RECORD	170, 172.5, 175	632 g	102 mm
CHORUS	170, 172.5, 175	667 g	102 mm
DAYTONA	170, 172.5, 175	646 g	111 mm
VELOCE	170, 172.5	659 g	111 mm
MIRAGE	170, 172.5	659 g	111 mm

To determine chainline, use a pair of precise calipers. Measure from the center of the seat tube, to the center of the crank arm spider, between the chainrings themselves. You should have a measurement not less than or more than 43.5 - 45 mm.

TRIPLE CRANKSETS

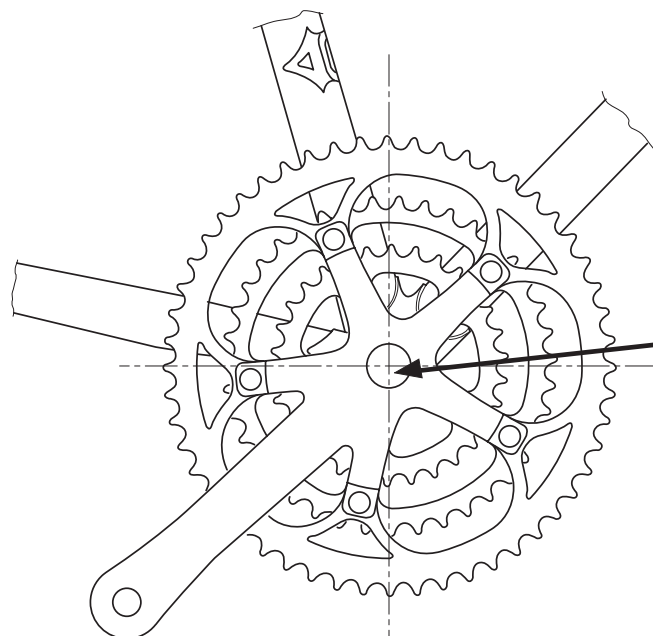

**torque to 32-38 N.m. or
23.6-28 Ft.lbs**

The use of a torque wrench is highly recommended to ensure proper crank arm assembly!

DO NOT grease BB-spindle when assembling crank arms!

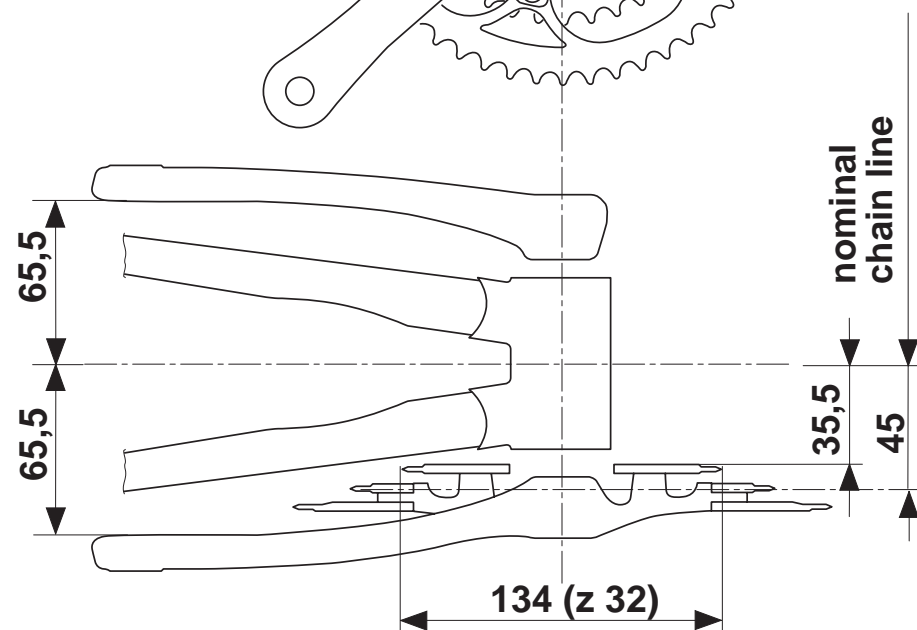

To determine chainline: Use a pair of precise caliper to measure from the center of the seat tube to the inside face of the smallest chain ring. Your measurement should be within 1.5mm of 35.5mm. You can also measure from the center of seat tube to the center of the teeth on the middle chain ring. You should have a number within 1.5mm of 45mm. If your measurements do not reflect these tolerances, you must adjust the crank set accordingly.

2000 TRIPLE CRANKSETS

model	item code	weight	spindle
RACING T	FC00-RA0000	735 g.	115 mm
VELOCE Triple	FC00-VL0022	731 g.	115 mm
MIRAGE Triple	FC00-VL0022	731 g.	115 mm

FRONT DERAILLEURS (Braze-on)

(for double chainrings)

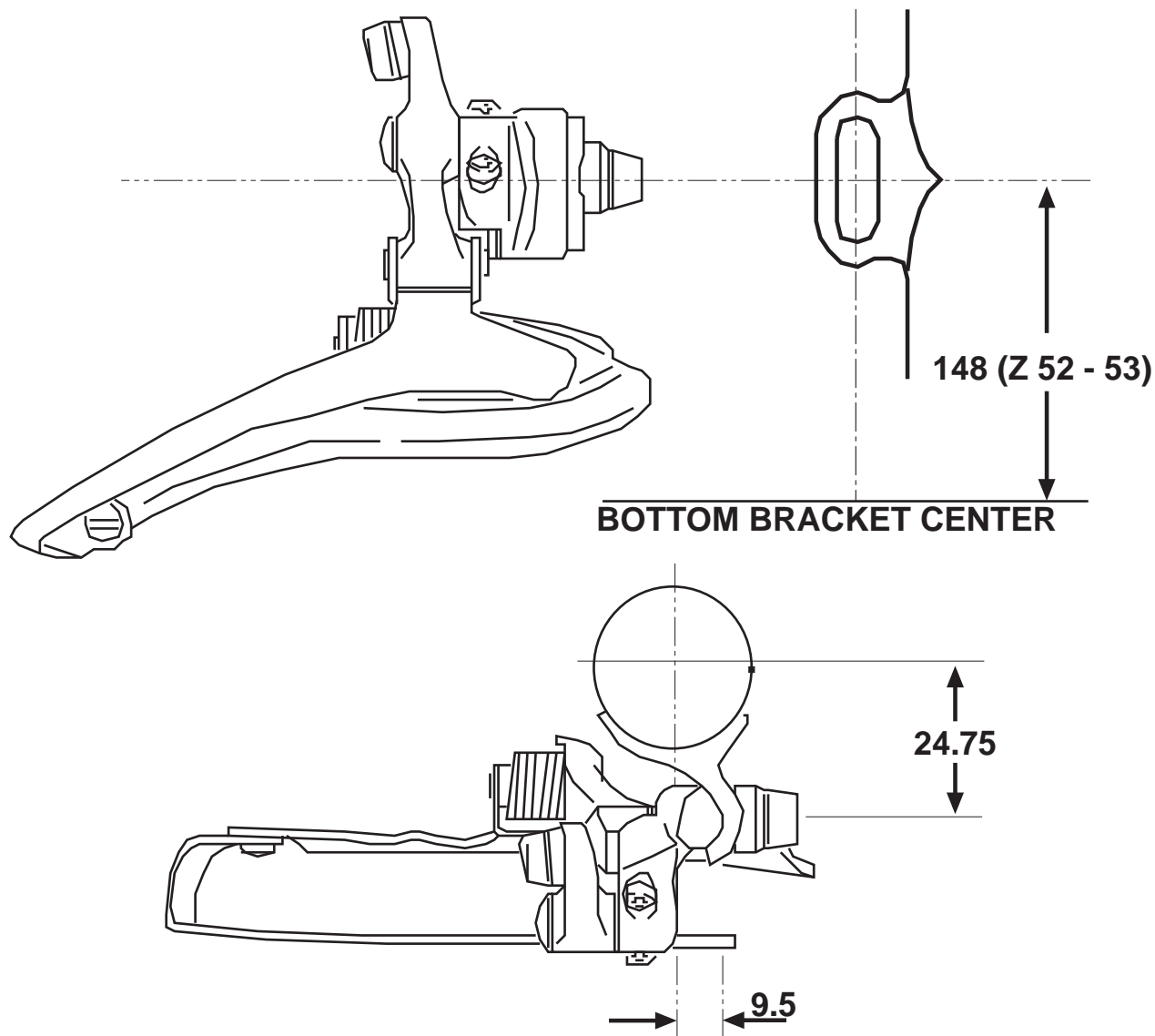

2000 FRONT DERAILLEURS (Braze On)

model	item code	weight	capacity	max. ring
RECORD	FD00-RE2S	89 g	15 teeth	54
CHORUS	FD00-CH2S	87 g	15 teeth	54
DAYTONA	FD00-DA2S	93 g	15 teeth	54
MIRAGE	FD99-MI2S	101 g	15 teeth	54

FRONT DERAILLEURS (Clamp On)

(for double chainrings)

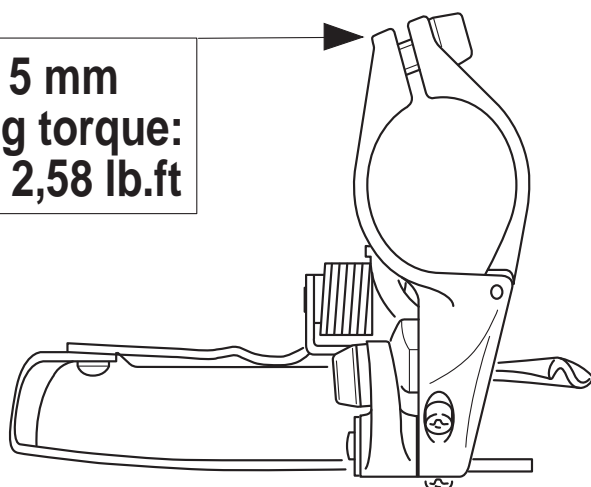

Allen key 5 mm
Tightening torque:
3,5 N. m - 2,58 lb.ft

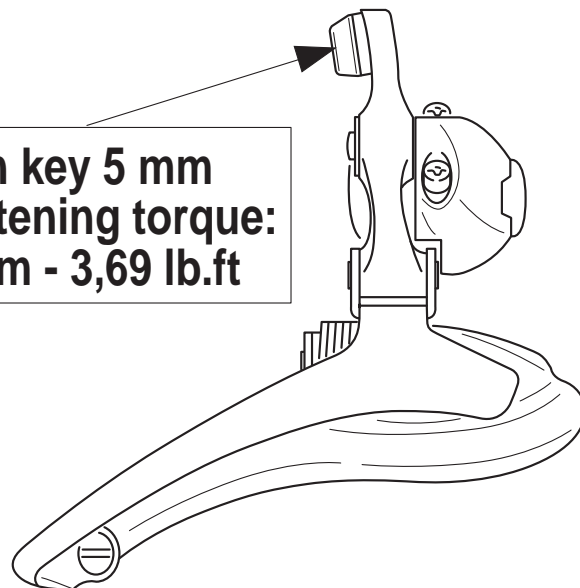

Allen key 5 mm
Tightening torque:
5 N. m - 3,69 lb.ft

2000 FRONT DERAILLEURS (clamp-on)

model		item code	weight	capacity	max. ring
RECORD	28.6	FD00-RE2F28	102 g.	15t	54t
RECORD	32.0	FD00-RE2F32	102 g.	15t	54t
RECORD	35.0	FD00-RE2F35	102 g.	15t	54t
CHORUS	28.6	FD00-CH2F28	100 g.	15t	54t
CHORUS	32.0	FD00-CH2F32	100 g.	15t	54t
CHORUS	35.0	FD00-CH2F35	100 g.	15t	54t
DAYTONA	28.6	FD00-DA2F28	100 g.	15t	54t
DAYTONA	32.0	FD00-DA2F32	100 g.	15t	54t
MIRAGE	28.6	FD99-MI2F28	115 g.	15t	54t
MIRAGE	32.0	FD99-MI2F32	115 g.	15t	54t

FRONT DERAILLEURS (Braze-on) (for triple chainrings)

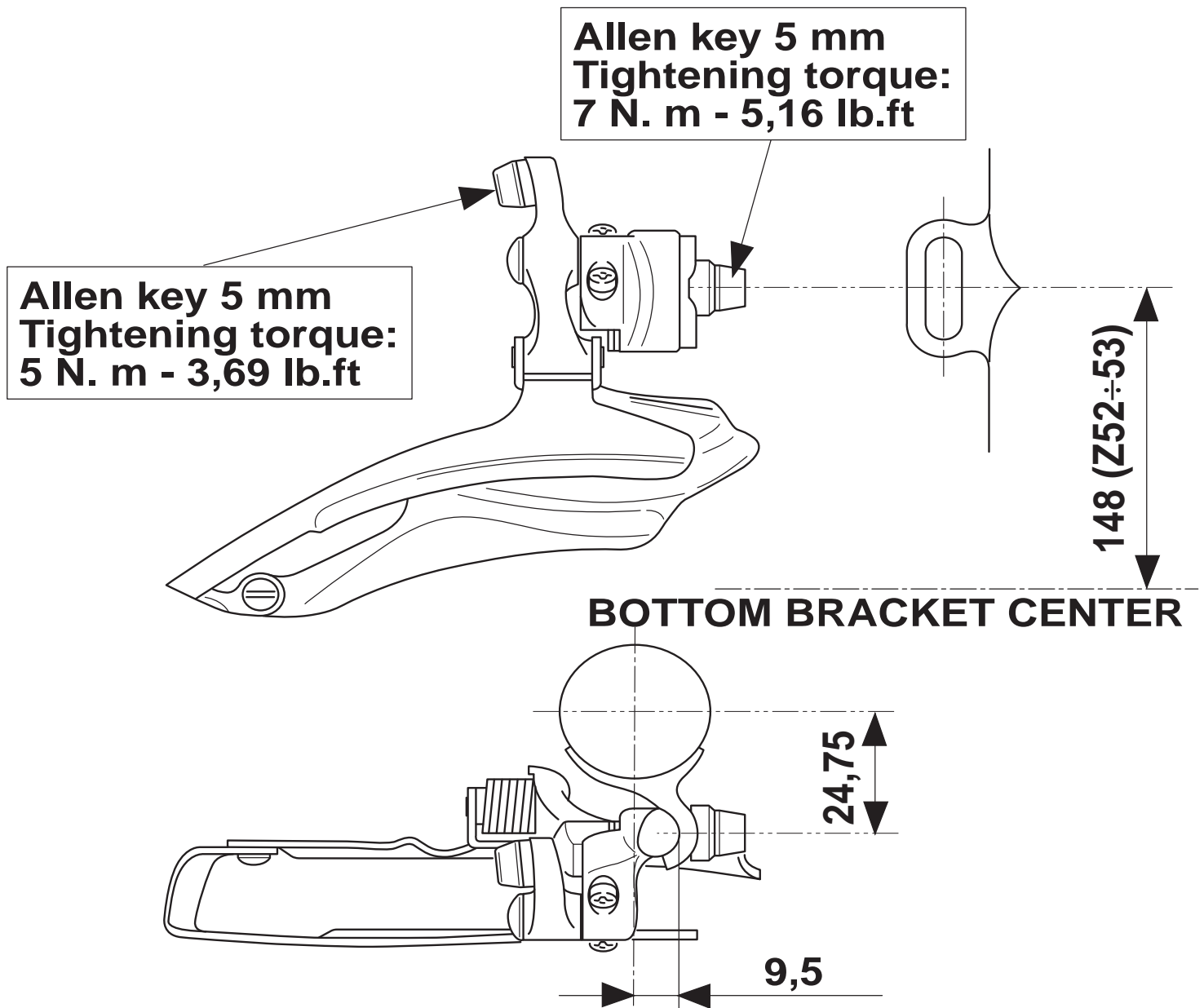

2000 TRIPLE FRONT DERAILLEURS (Braze-on)				
model	item code	weight	capacity	max. chainring
RACING T	FD00-RA3S	107 g.	22 teeth	52 teeth
VELOCE Triple	FD00-DA3S	107 g.	22 teeth	52 teeth
MIRAGE Triple	FD99-MI3S	118 g.	22 teeth	52 teeth

FRONT DERAILLEURS (Clamp-on)

(for triple chainrings)

Allen key 5 mm
Tightening torque:
5 N. m - 3,69 lb.ft

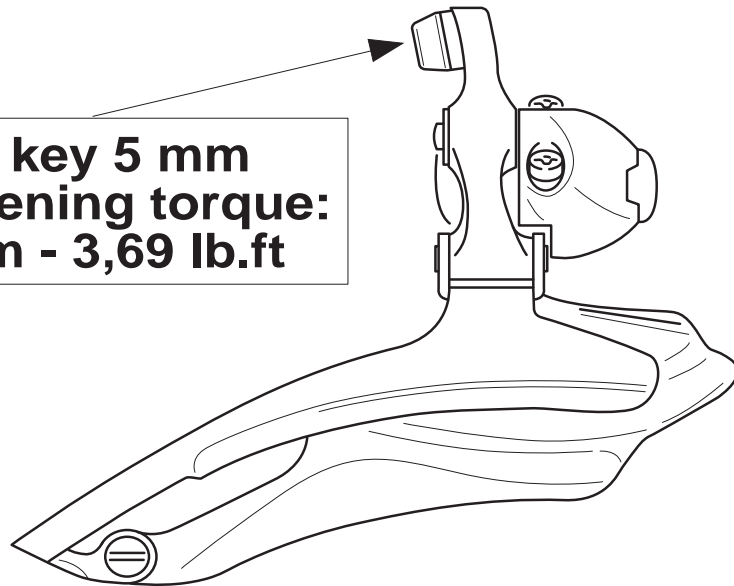

Allen key 5 mm
Tightening torque:
3,5 N. m - 2,58 lb.ft

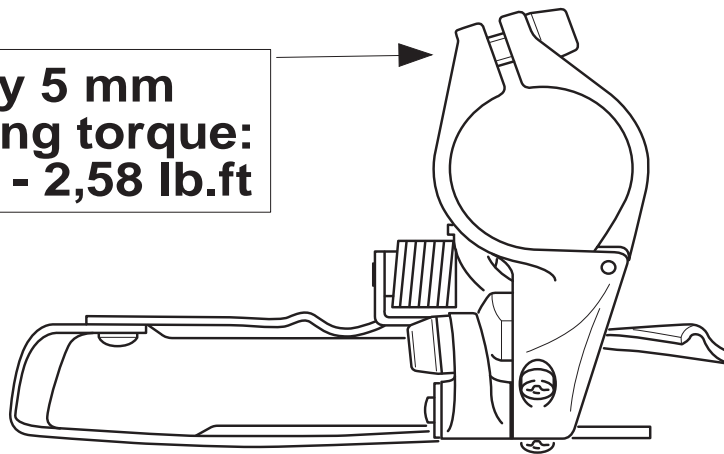

2000 TRIPLE FRONT DERAILLEURS (Clamp-on)					
model		item code	weight	capacity	max. ring
RACING T	28.6	FD00-RA3F28	114 g.	22 t.	54 t.
RACING T	32.0	FD00-RA3F32	114 g.	22 t.	54 t.
RACING T	35.0	FD00-RA3F35	114 g.	22 t.	54 t.
DAYTONA Triple	28.6	FD00-DA3F28	114 g.	22 t.	54 t.
DAYTONA Triple	32.0	FD00-DA3F32	114 g.	22 t.	54 t.
MIRAGE Triple	28.6	FD99-MI3F28	132 g.	22 t.	54 t.
MIRAGE Triple	32.0	FD99-MI3F32	132 g.	22 t.	54 t.

REAR DERAILLEURS

(with short cage)

Allen key 5 mm
Tightening torque:
15 N. m - 11,07 lb.ft

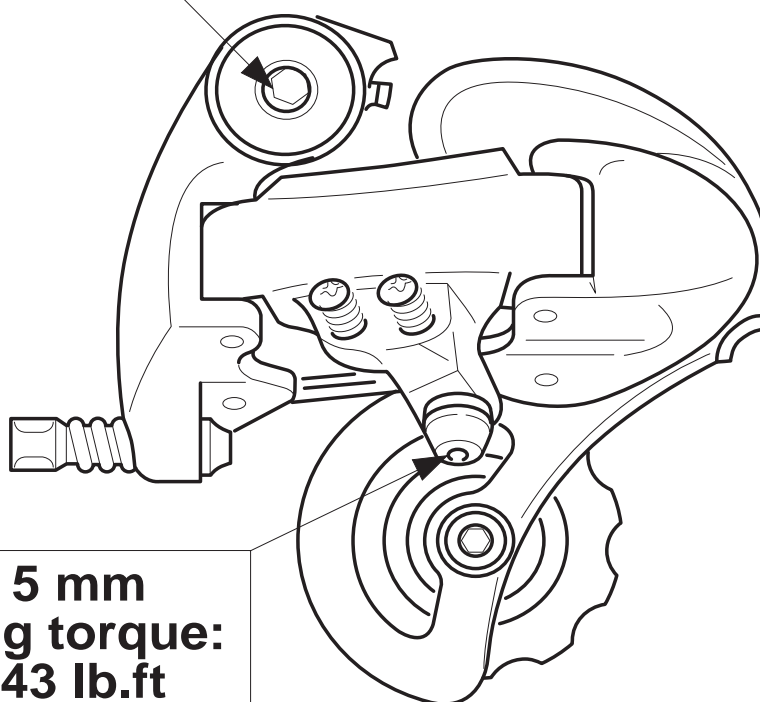

Allen key 5 mm
Tightening torque:
6N. m - 4,43 lb.ft

2000 REAR DERAILLEURS					
model		item code	weight	max. cog	capacity
RECORD	10 speed		188 g.	29 t*	
RECORD	9 speed	RD00-RE209	209 g.	26 t	27 t
CHORUS	10 speed		214 g.	26 t	27 t
CHORUS	9 speed	RD00-CH209	243 g.	26 t	27 t
DAYTONA	9 speed	RD00-DA209	237 g.	26 t	27 t
VELOCE	9 speed	RD00-VL209	251 g.	28 t	27 t
MIRAGE	9 speed	RD99-MI209	271 g.	28 t	26 t

TRIPLE REAR DERAILLEURS

(with long cage)

Allen key 5mm
Toghtening torque
15N.m or 11.07 Ft.lbs

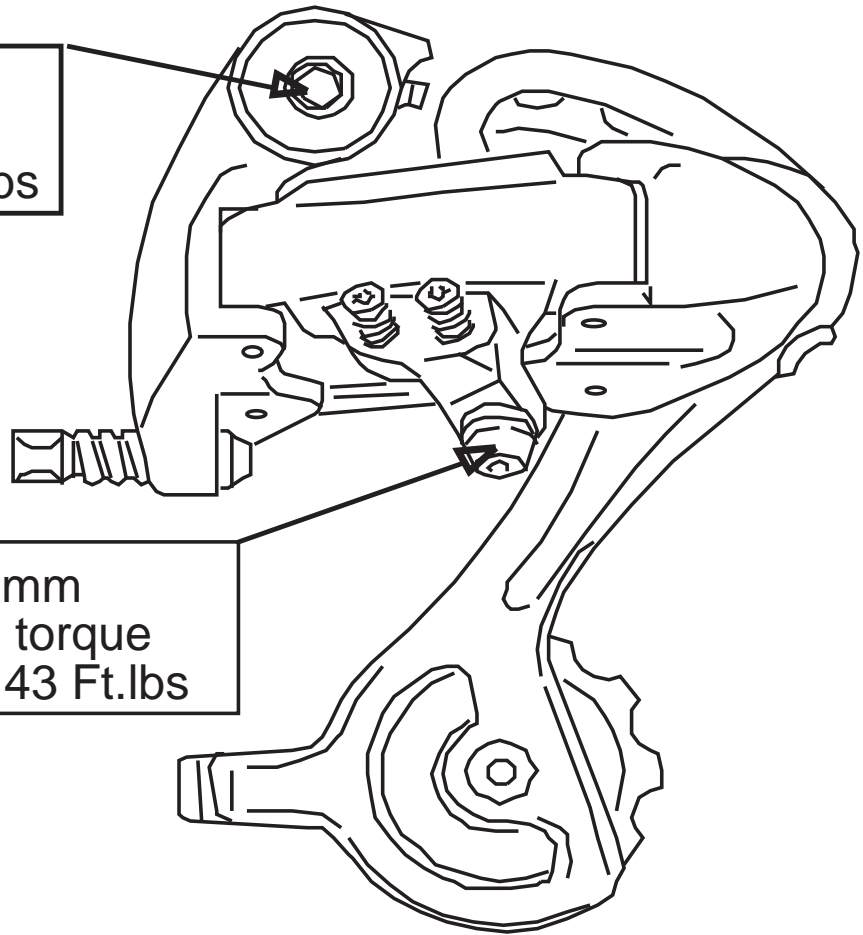

Allen key 5mm
Toghtening torque
6 N.m or 4.43 Ft.lbs

2000 TRIPLE REAR DERAILLEURS

model	item code	weight	capacity	max. cog
RACING T	RD00-RA309	259 g.	37 t	28 t
VELOCE Triple	RD99-VL309	268 g.	37 t	28 t
MIRAGE Triple	RD99-MI309	288 g.	37 t	28 t

9 SPEED CASSETTE HUBS (Standard)

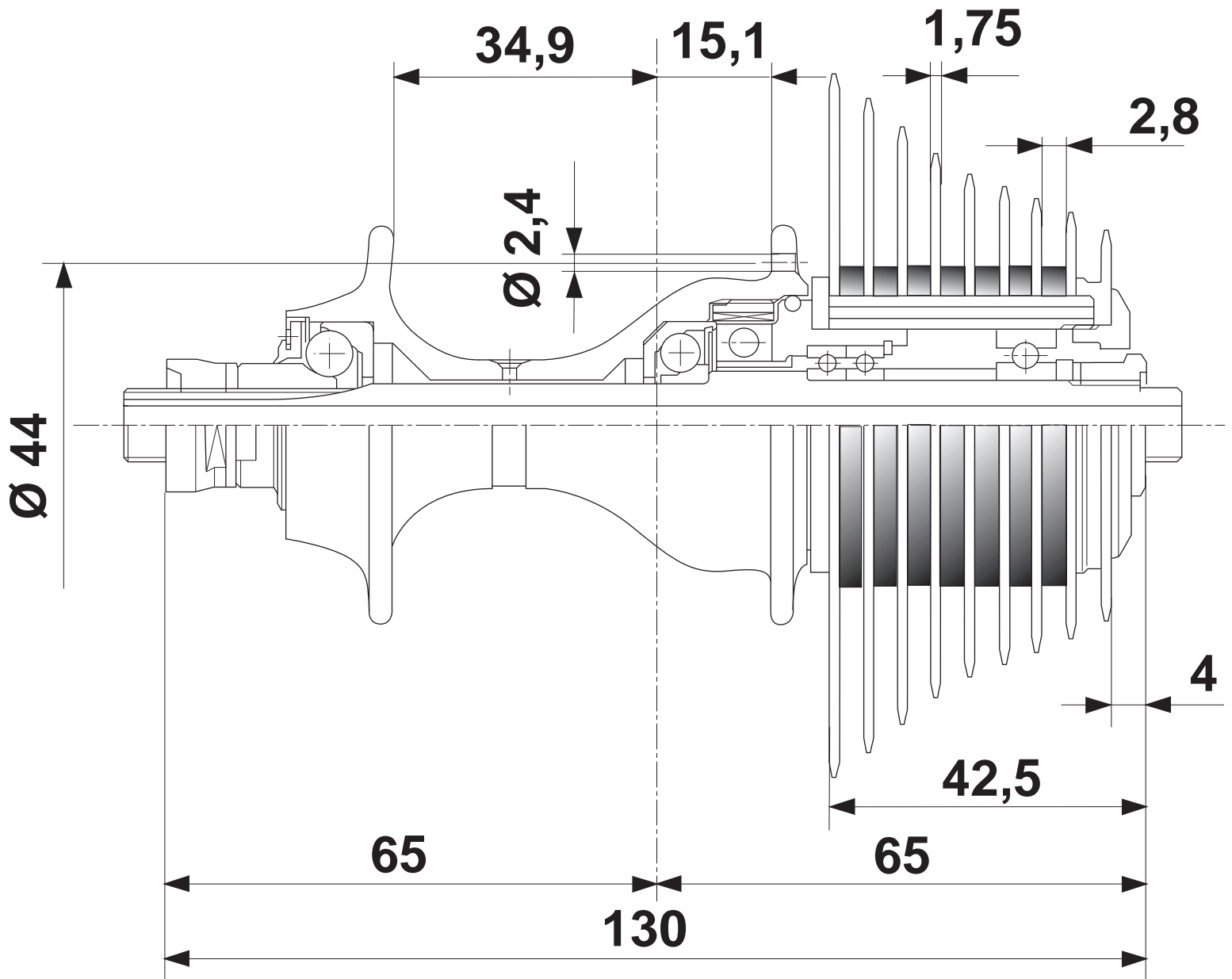

2000 9-Speed REAR HUBS (standard)		
model	item code	weight (*)
VELOCE	FH00-VL3209	458 g.
MIRAGE	FH00-MI3209	447 g.

All weights include quick release

REAR HUBS 9-Speed (Oversize)

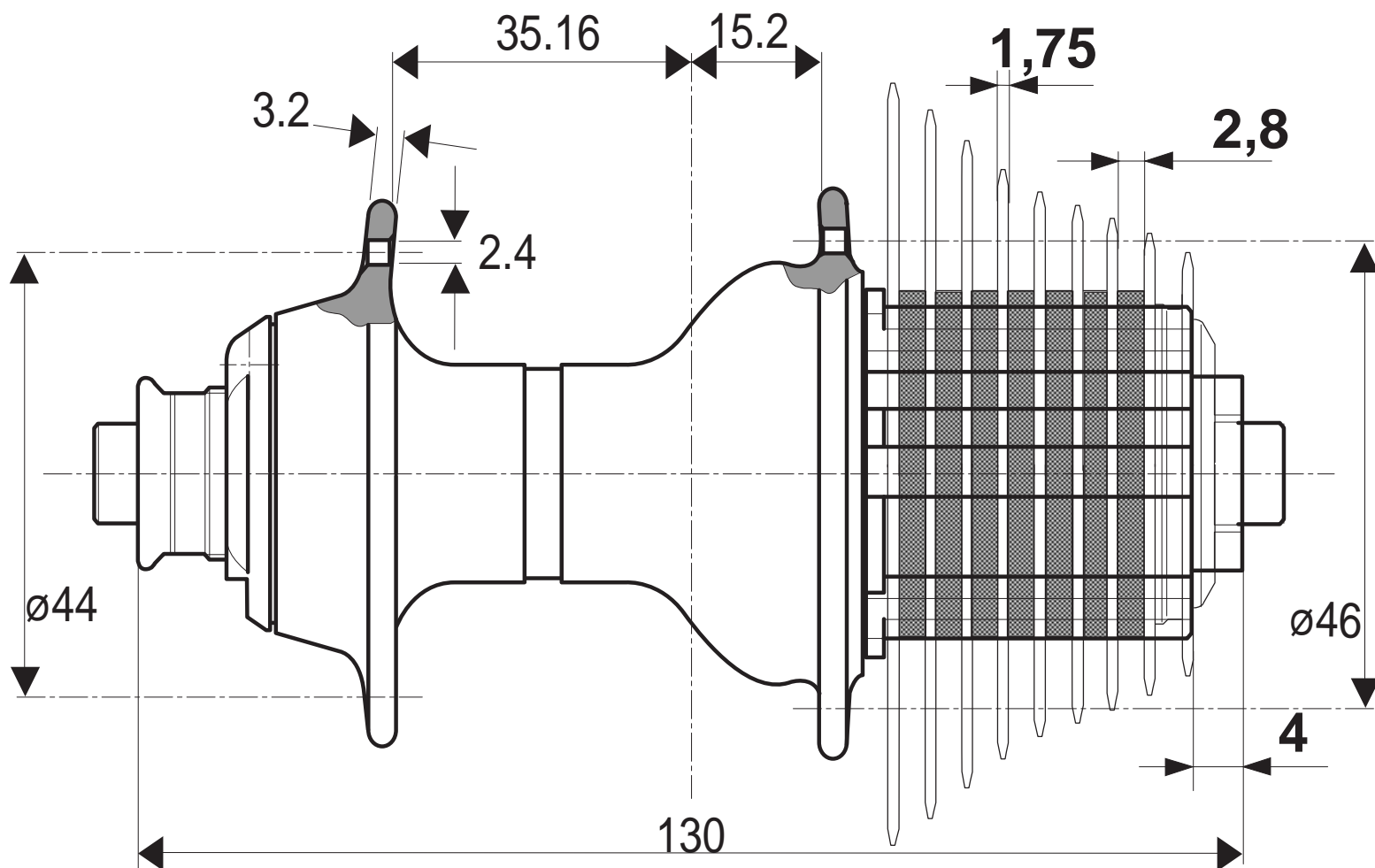

2000 9-Speed REAR HUBS (Oversize)		
model	item code	weight
RECORD	FH99-RE2809	316 g.
CHORUS	FH99-CH3209	326 g.
DAYTONA	FH00-DA3209	332 g.

All weights include skewer

10 SPEED DRIVE SYSTEM

Record & Chorus

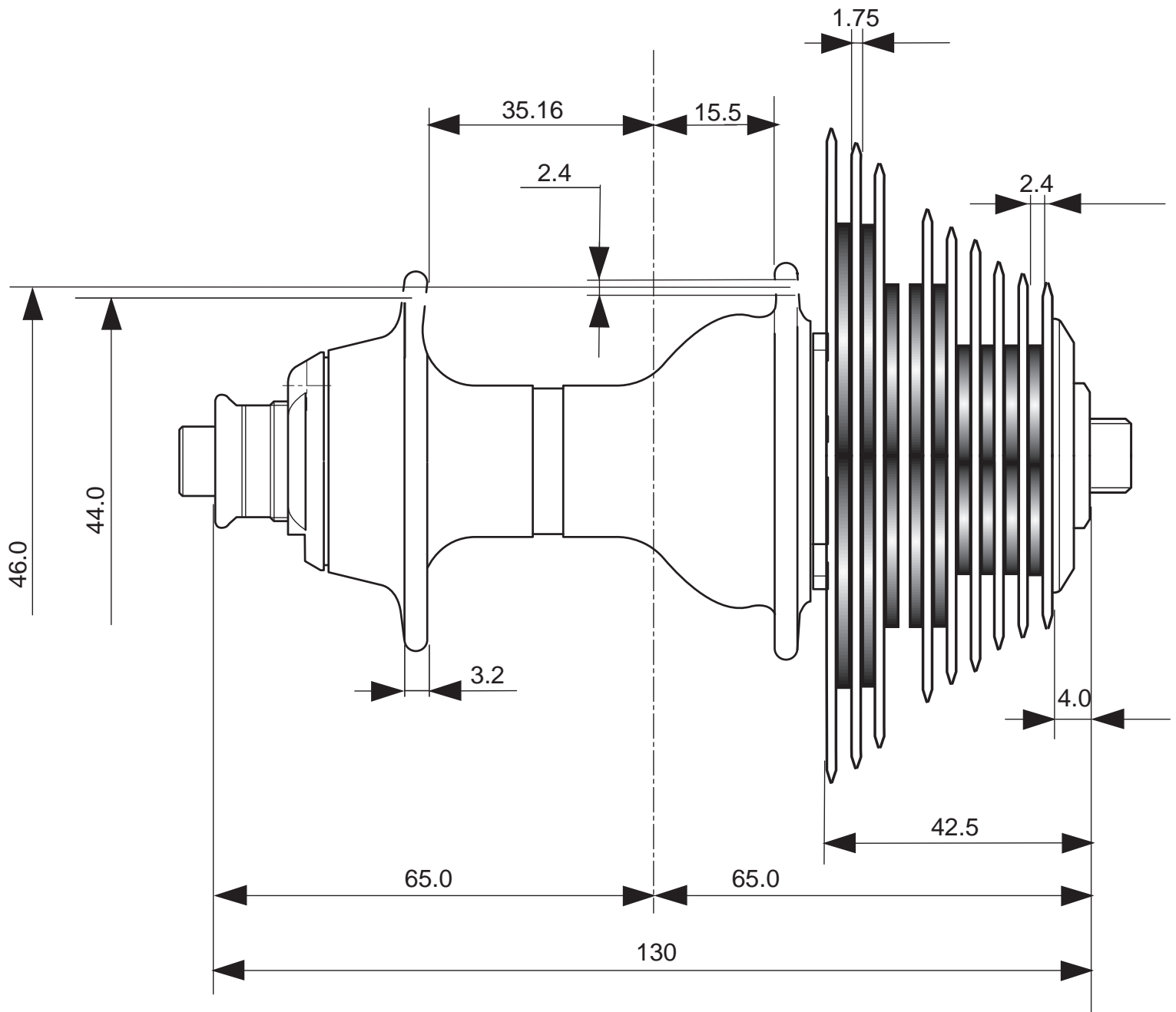

2000 10 & 9 SPEED CHAINS

The six 10-speed components, essential for adequate performance are:

- a.) 10-speed cassette
- b.) 10-speed chain
- c.) 10-speed rear derailleur
- d.) 10-speed front derailleur
- e.) 10-speed compatible large chain ring
- f.) 10-speed indexed rear derailleur shifter

*(note that it is not necessary to change a 9 speed rear hub to accommodate a 10-speed drive system.)

The five 9-Speed components, essential for adequate performance are:

- a.) cassette hub with a 9-Speed free-hub body *
- b.) any Campagnolo 9-Speed cassette
- c.) 9-Speed chain
- d.) 9-Speed rear derailleur
- e.) 9-Speed indexed rear-derailleur shifter

* (note that a standard 8-Speed hub can be up-graded to a 9-Speed hub, by replacing the original 8-Speed freehub-body with a 9-Speed body; refer to rear hub overhaul procedure p. 26)

WARNING: DO NOT under any circumstances attempt to replace the freehub bodies on any Campagnolo factory assembled 8-speed wheels with a 9-speed freehub body. Preassembled Campagnolo 9-speed wheels have customized hubshells providing narrower dish.

2000 10 and 9 Speed Chains		
model	width	weight *
RECORD 10spd	6.1mm	280 g *
RECORD 9spd	6.8mm	300 g *
DAYTONA 9spd	6.8mm	300 g *

* = 114 links

FRONT HUBS (Oversize)

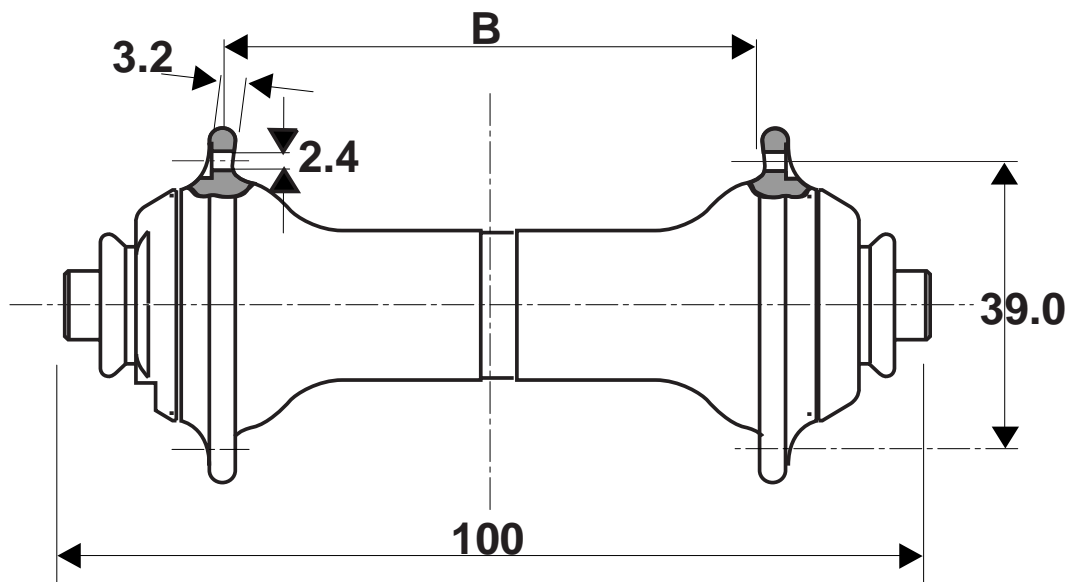

2000 FRONT HUBS (Oversize)			
model	item code	weight	B
RECORD	HB99-RE28	181 g.	67.5
CHORUS	HB00-CH32	180 g.	66.0
DAYTONA	HB00-DA32	186 g.	66.0

All weights include skewer

FRONT HUBS (Standard)

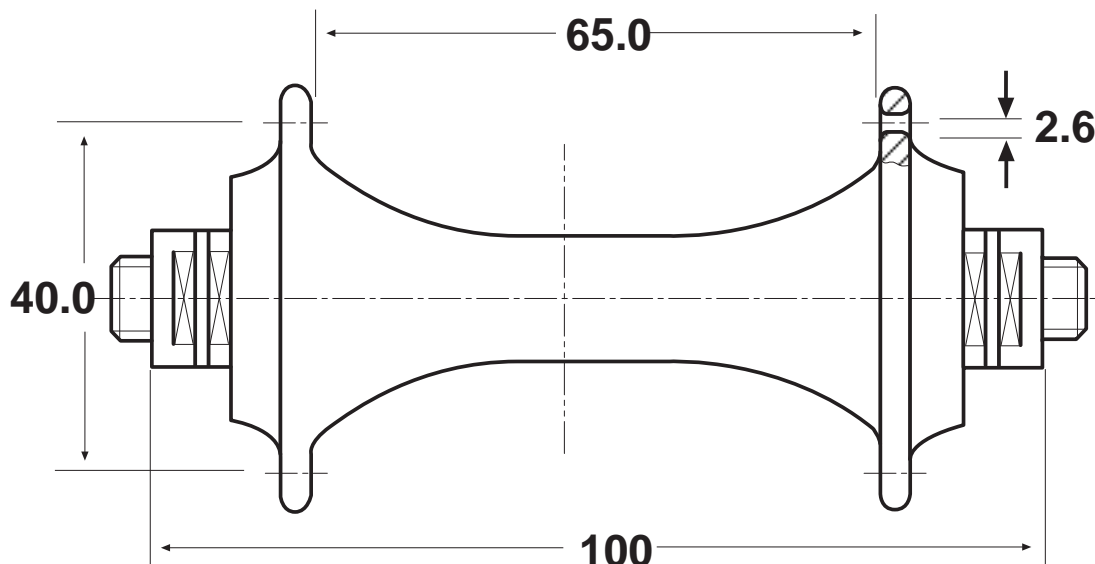

2000 FRONT HUBS (Standard)		
model	item code	weight
VELOCE	HB00-VL32	241 g.
MIRAGE	HB00-MI32	226 g.

All weights include quick release

DUAL-PIVOT BRAKE CALIPERS

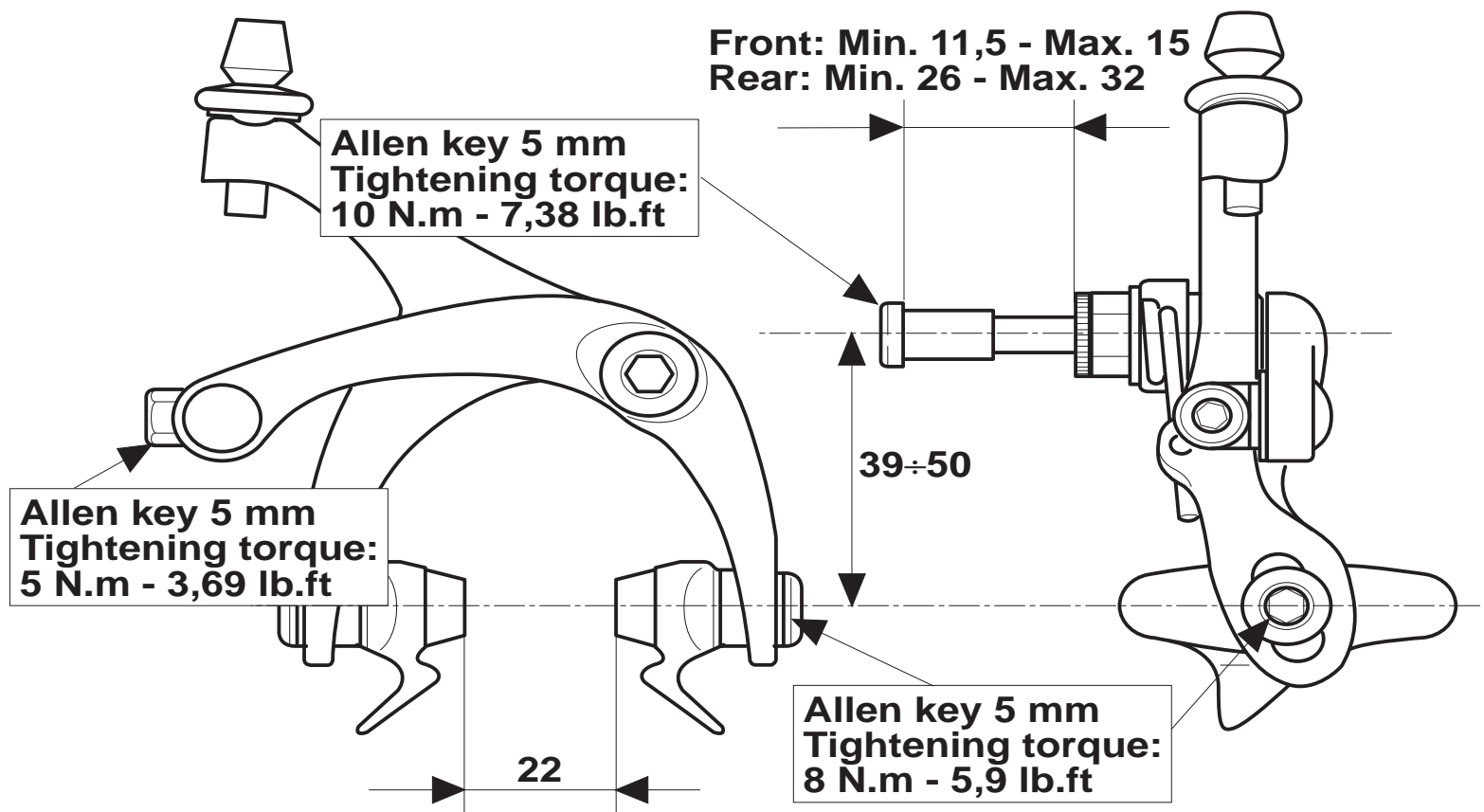

2000 DUAL PIVOT BRAKES		
model	item code	weight
RECORD	BR00-RE	355 g.
CHORUS	BR00-CH	380 g.
DAYTONA	BR00-DA	374 g.
VELOCE	BR00-VL	380 g.
MIRAGE	BR00-VL	380 g.

ERGOPOWER CONTROLS

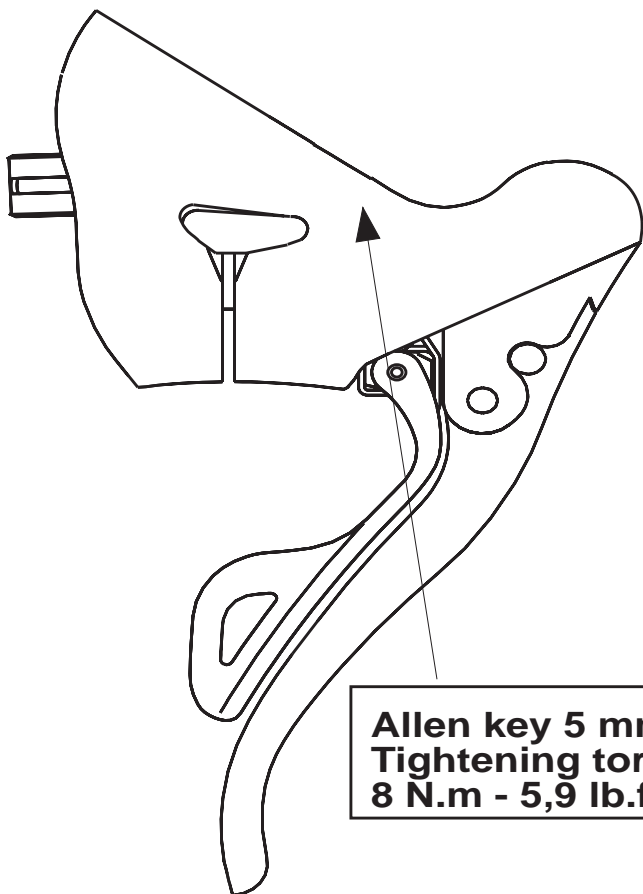

Allen key 5 mm
Tightening torque:
8 N.m - 5,9 lb.ft

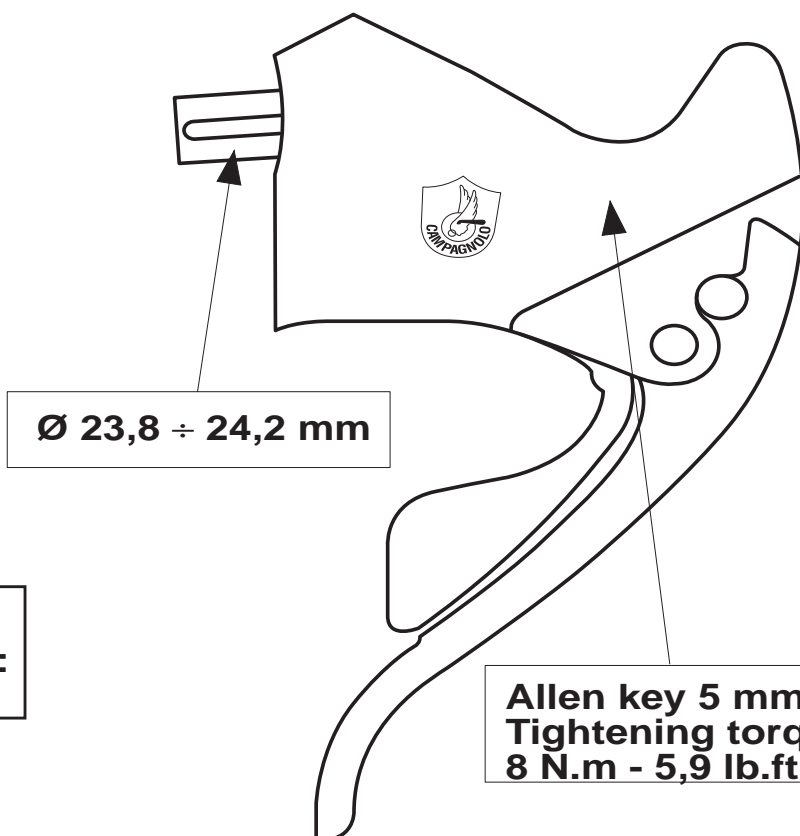

Ø 23,8 ÷ 24,2 mm

Allen key 5 mm
Tightening torque:
8 N.m - 5,9 lb.ft

2000 ERGOPOWER CONTROLS

model	item code	# of gears	body material	weight
RECORD 10 spd		10-speed	Carbon	342 g*
RECORD 9 spd	EP00-RE09CG	9-speed	Carbon	365 g*
CHORUS 10 spd		10-speed	Carbon	378 g*
CHORUS 9 spd	EP00-CH09CG	9-speed	Carbon	387 g*
DAYTONA 9 spd	EP00-DA09CG	9-speed	Composite	399 g*
VELOCE 9 spd	EP00-VL09CG	9-speed	Composite	402 g*
MIRAGE 9 spd	EP00-MI09CG	9-speed	Composite	400 g*

SEAT POST

Record, Chorus

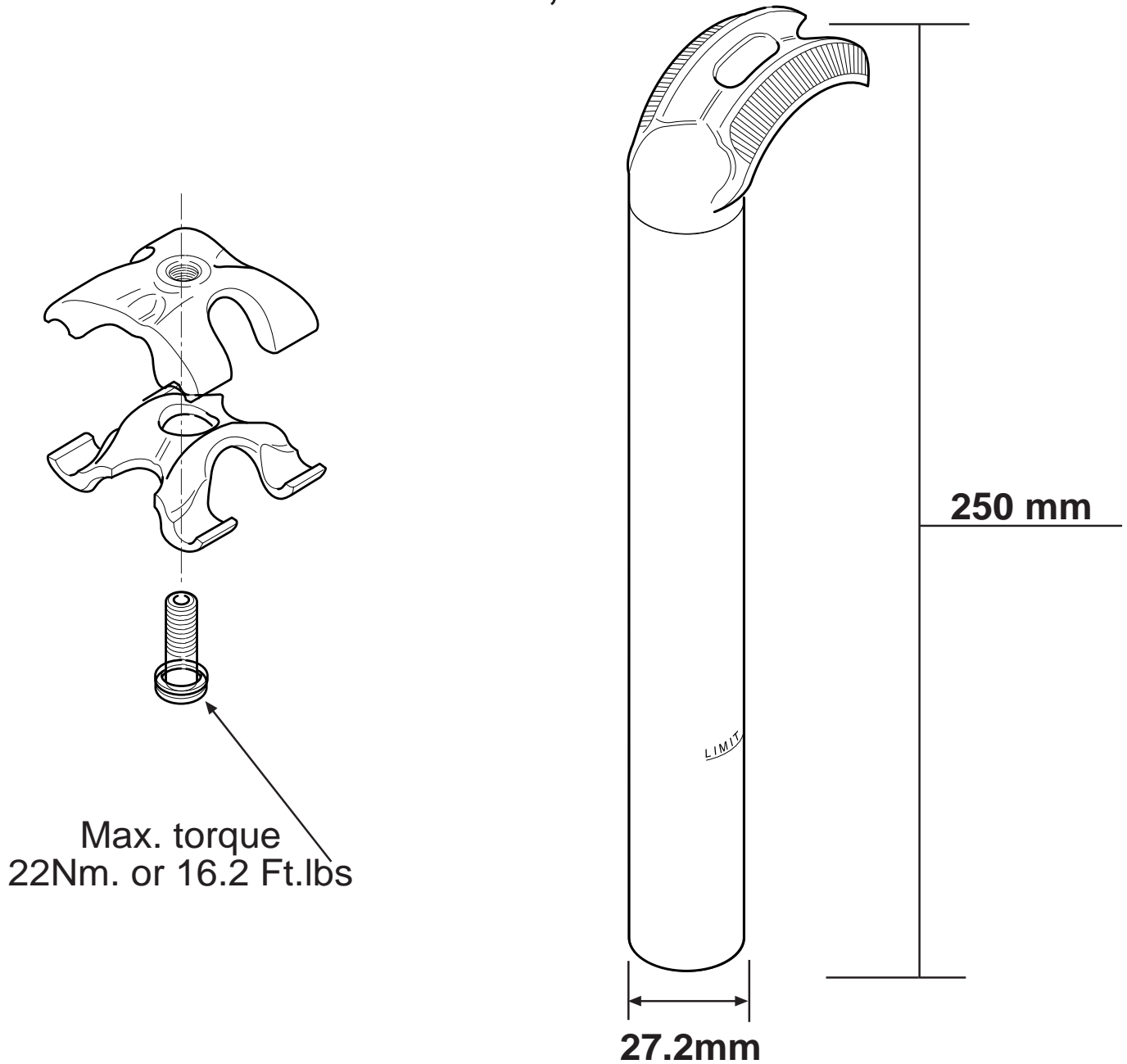

2000 SEAT POST

model	code	length	diameter	material	weight
RECORD	SP00-RE272C	250mm	27.2mm	Carbon	180 g.
RECORD	SP99-RE272T	250mm	27.2mm	Titanium	195 g.
CHORUS	SP00-272CH	250mm	27.2mm	Steel	230 g.

PRO-FIT PEDAL SYSTEM

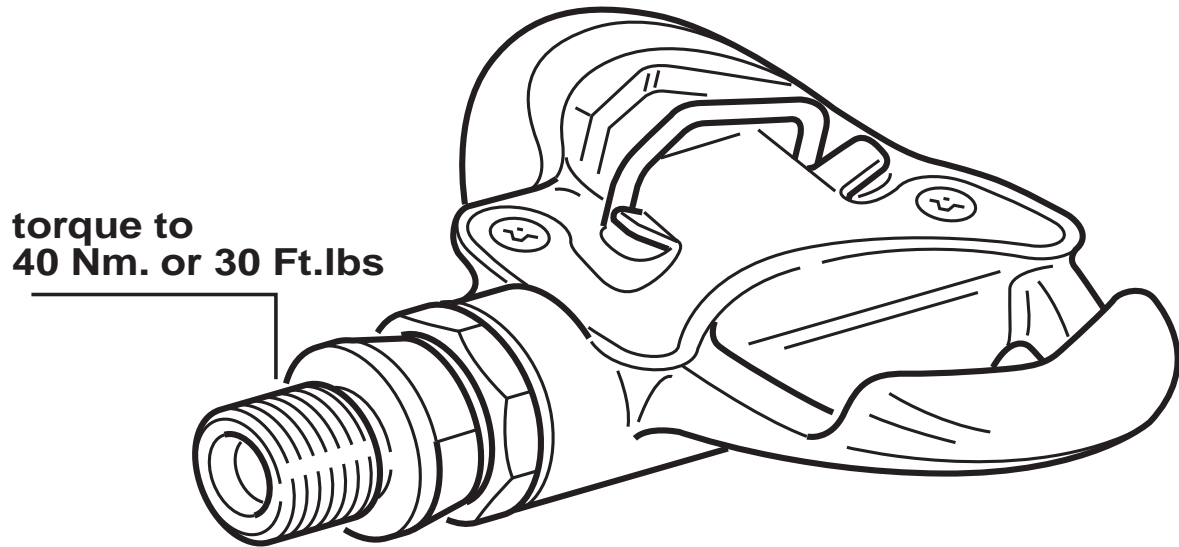

2000 PRO-FIT PEDAL SYSTEM			
model	item code	weight	spindle material
Record	PD00-RE	265 g.	Titanium
Chorus	PD00-CH	325 g.	Steel
Daytona	PD00-DA	310 g.	Steel

WARNING: DO NOT over adjust the release tension adjustment screw.

TORQUE SPECIFICATIONS

Bottom Brackets: 70 N.m. / 51.66 Ft.lbs

Cranksets:

- a) Fixing bolts: 32-38 N.m. / 23.6-28 Ft.lbs**
- b) Chainring bolts: 10.84 - 13.55 N.m. / 8 -10 Ft.lbs**

Front Derailleurs Braze / Clamp - On:

- a) Fixing bolts braze on: 7 N.m. / 5.16 Ft.lbs**
- b) Fixing bolts Clamp on: 3.5 N.m. / 2.58 Ft.lbs**
- c) Cable clamp bolt: 5 N.m. / 3.69 Ft.lbs**

Rear Derailleurs:

- a) Fixing bolt: 15 N.m. / 11.07 Ft.lbs**
- b) Cable clamp bolt: 6 N.m. / 4.43 Ft.lbs**

Ergopower Levers: 8 N.m. / 5.9 Ft.lbs

Brake Levers: 10 N.m. / 7.38 Ft.lbs

Dual Pivot Brakes:

- a) Fixing bolt: 10 N.m. / 7.38 Ft.lbs**
- b) Brake pad fixing bolt: 8 N.m. / 5.9 Ft.lbs**
- c) Cable clamp bolt: 5 N.m. / 3.69 Ft.lbs**

Cassette Lockring: 50 N.m / 36.87 Ft.lbs

Seat Binder Bolt: 4 - 6.75 N.m. / 3 -5 Ft.lbs

Seat Clamp Fixing Bolt:

- a) 1999 Seat post : 22 N.m. / 16.2 Ft.lbs**
- b) Seat Tube Tightening For 1999: 12 N.m. / 8.8 Ft.lbs**

Quick Release:

- a) To Tighten: 54.2 N.m. / 40 Ft.lbs**
- b) To Release: 16.2 - 33.8 N.m. / 12 - 25 Ft.lbs**

Headset Locknut: 33.9 N.m. / 25 Ft.lbs

Pedals:

- a) SGR Pedals: 45 N.m. / 33 Ft.lbs**
- b) Clipless style : 40 N.m / 29.5 Ft.lbs**
- c) Track w/Straps: 45 N.m. / 33 Ft.lbs**
- d) Pro-Fit Pedal System: 40 N.m. / 29.5 Ft.lbs**